

## Garden Window & Fence JND401/402 – by John Lockwood



Instructions compiled by June Smith.

As always, I would recommend that you read the instructions through to the end before you commence any project.

The new Garden Flowers and Window collection is released as from Monday 22<sup>nd</sup> May, there is a separate You Tube video and set of instructions for each of the flowers and window box sets. We are starting today with the Garden Flowers and Fence die set. I would advise that you visit them as well as following these instructions.

**June's Tips:** This applies to any die, place your pieces onto your cutting plate at an angle, this helps to cut the dies in one pass. Also use your glue eraser to remove any unwanted marks.

### Information:

- The Garden Window die set consists of 3 dies, the outside stitched die (No. 1) measures 4" x 6" which is a perfect scrap booking size for the card today. Die 2 is the outer arched window and die 3 is the inner window panels.

### Materials

5" x 7" White Card Blank  
Garden Window JND401 (3)  
Garden Fence JND402 (6)

Kraft Card  
Coconut White Card  
Wisteria Card  
Fusion Reactive Sprays in Mint and Bubblegum.  
Versafine Vintage Sepia Ink Pad  
Piece of Acetate  
3M Craft Mount Permanent Adhesive Spray  
Craft Kit

**Method:**

- Take a piece of Kraft card, and dies 2 & 3 together, using John's long piece of tape trick of picking up the inner die, then using the low take tape as handles you can position the die in the exact position inside the outer die and press down. At the same time, we can add the inner and outer dies from the window box set and tap these down, then cut out using your die cutting machine.

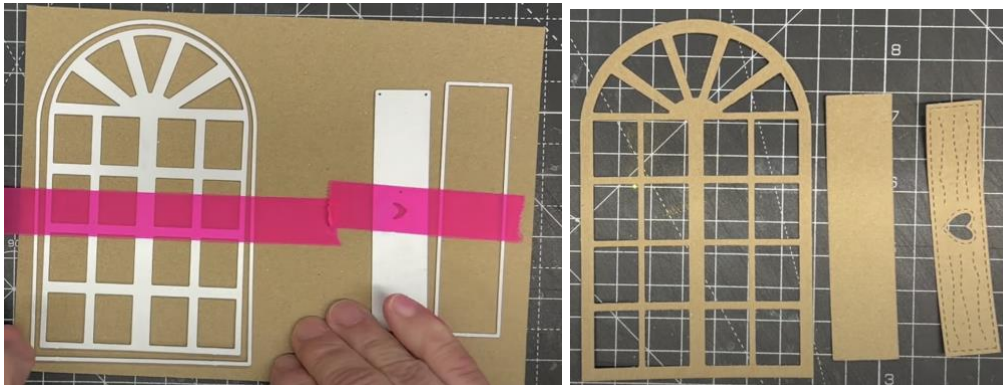

- We now need to add a bit of colour to the kraft pieces, so take a piece of copy paper or card, lay this onto your tabletop with the die cut pieces, then using the Versafine Sepia ink pad and a finger dauber, go around the edges as shown below, to give it that aged look.

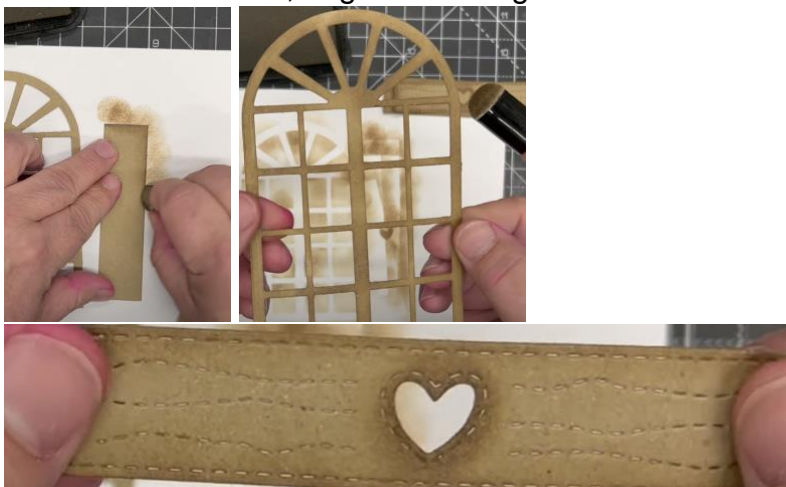

- You also get a beautiful panel showing the inked areas on the card/paper that you used as a base, you can use these as the background for another card.



- Add a little bit of foam tape to the back of the window box, the one with the heart cut out of it, and add this to the front of the window box background, to give the window box some dimension.



- From your Coconut White card, cut out die no 1, the outside stitched die, which gives you a perfect 4" x 6" panel, then add die no 3, the windows with tape and cut that out using your die cutting machine.
- Cut a piece of acetate to 4" x 6", we need to stick this behind the window, the easiest thing to use for this is the 3M Craft Mount Permanent Adhesive Spray, or you could use the powertape. Add foam tape to the back of the window.
- We then need a piece of background card; John has used the new Craft Artist Fusion reactive Sprays in Mint and Bubblegum to create a sky background, but you can use anything from your stash that you have.

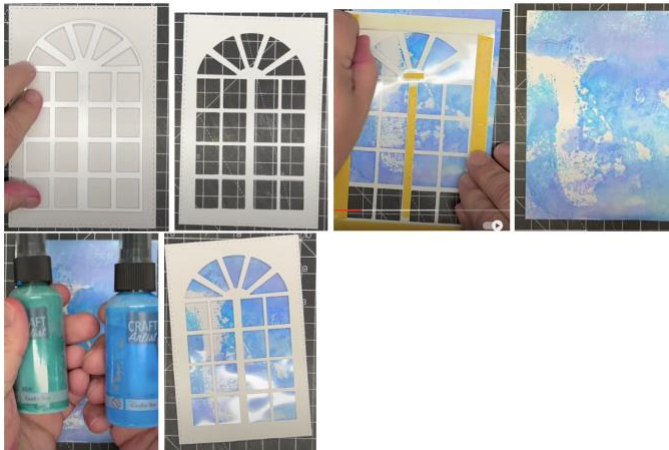

- Add foam tape to the back of the acetate, making sure you have a thin strip down the middle and a little bit where the window fans out, that way the design will not flop in the middle. Remove the yellow backing tape, add onto your blue piece. If you have any excess showing, just use a pair of scissors to undercut and trim it off.
- Bring back in your kraft card window and using the fine glue applicator add wet glue to the back of the frame. Then add this onto your white window, you can put it exactly over the top or offset it slightly which is what John has done.

**Tip:** These would make fantastic backdrops for your Christmas Cards.

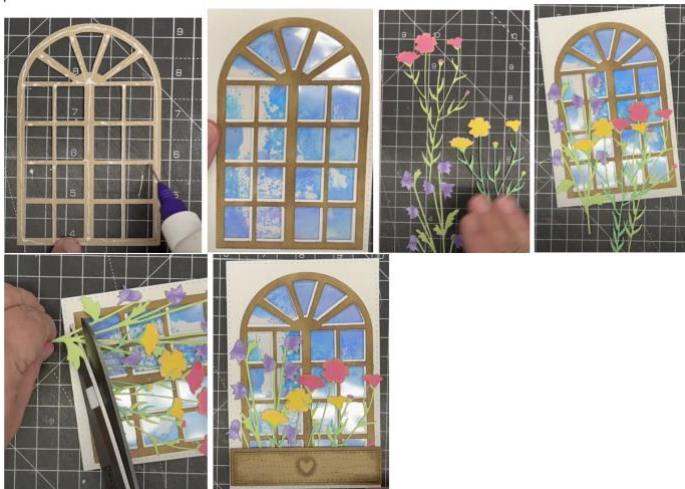

- John is using some of the Garden Flowers - the Willow Herb, & Bluebells set (there are separate video instructions showing how to do these). Turn the flowers over and add wet glue to the backs and flat glue them onto the bottom of the window, so that the bottom of the flowers is hanging over, then before you snip off the excess at the bottom use your pokey tool to mix the flower heads (see the photo) you can then simply snip the ends off with your scissors – you can use these pieces as foliage on another project.
- Then bring back in your front window box panel add foam tape to the back and add over the bottom of the flowers.



- We then need to use some of the Kraft card and Wisteria card to make a matt & Layer panel to go onto our card blank, what we have done is to bring in some of the colours from the flowers to make the layers, so you could have used the Hot Pink or Yellow card, the choice is yours.



I hope you have enjoyed these instructions.