

JND398 Stag Band & JND396 Stag Circle (Simple) –by John Lockwood



Instructions compiled by June Smith.



John has created a 'You Tube' video dated 17 June 2023 using the 'Stag Band & Stag Circle' die sets to create a relatively complex card.

As always, I would recommend that you read the instructions through to the end before you commence any project.

June's Tips: This applies to any die, place your pieces onto your cutting plate at an angle, this helps to cut the dies in one pass. Also use your glue eraser to remove any unwanted marks.

Die Information:

- 1 - Mistletoe Corner – 6" x 6" - cuts a mistletoe in 4 corners that stay within the circle
- 2 - Cutting Circle – 5 $\frac{3}{4}$ " so you can have a circular aperture.
- 3 - Leaping Stag Circle – 5 pairs of leaping stags and a snowflake symmetrically designed around the circle, with a heart at the top. It also has John's snowflake so you can use this with previous Christmas dies.
- 4 - Small Cutting Circle – 3 $\frac{1}{8}$ "
- 5 - Central circle – 3" which has a bigger version of the heart from the top of die 3, some little swirls and also the leaping stags across the front. This just cuts into the card so you can combine the circle dies to create layers.
- 6- Separate Leaping Stags which you can layer up onto die 5 or can be used on its own.

John's Tape Trick:

Pick up the inside die, hover over the outside die until it is in the right position and press the repositionable tape down, you can then use the ends as handles to place them over another die or place onto your card and cut out the shapes.

Materials:

6" x 8" Top Folding White Card (you could trim down an 8" x 8" card)

Stag Band – JND398 (3)

Stag Circle – JND396 (6) using dies 4, 5 and 6 only.

Essential Coconut White card

Craft Artist Christmas Red card

Craft Artist Christmas Green card

9mm Blue Power Tape

Green & White Bakers Twine

Pinflair

Craft Kit.

Preparation:

Mat & Layers:

- Essential Coconut White Card 6" x 6"
- Essential Coconut White Card 5⁵/₈" x 7⁵/₈"
- Christmas Red Card 5³/₄" x 7³/₄"
- Christmas Green Card 5⁷/₈" x 7⁷/₈"

Method:

- Take a scrap of the white card, add the outer die to it - also a piece of Christmas red card and add the inner die to that, run through your die cutting machine, you will need to do this twice. Use Spray glue onto the back of the red stags and adhere onto the white backs.
- Cut a piece of Coconut White card to 4¹/₂" x 4¹/₂", add a strip of 9mm blue powertape along the top and bottom, remove the blue covering, and add the red stag pieces onto the sticky end making sure it is point to point and there are no sticky parts showing.



- Turn the piece over and add foam tape around the back. Then reveal the tape from the left- and right-hand sides. Bring in your white & Green Bakers Twine, or similar, press down the end onto the foam tape and simply wrap it around crossing over at the front 3 times in total, press the end onto the other foam tape, keep a little bit of the twine as we will need it.

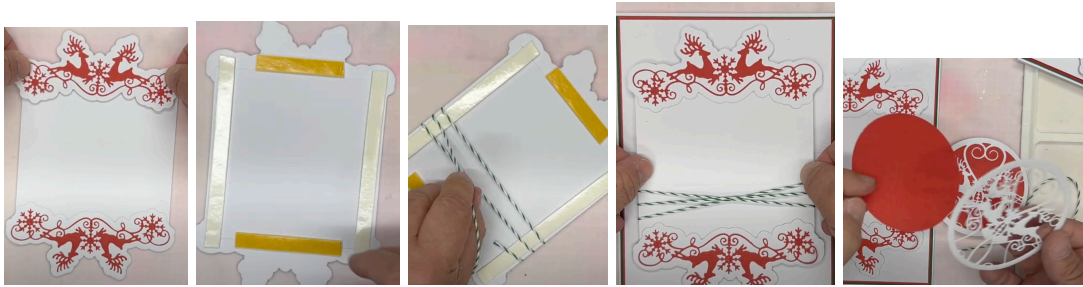

- From the Stag Circle die set, cut out dies 4 & 5 together from White card, then cut the Christmas Red circle piece from die 5 only.
- Using your 3M Spray Adhesive adhere the white circle onto the red. Add foam tape to the back and adhere this onto the centre of your card making sure it is lined up with the top and bottom stags.
- Double over the left-over piece of twine, then using a pair of tweezers poke in under the right-hand green twine, pull it through and knot it, this just balances with the Christmas Green from the layers. Snip off where the twine was doubled over to form a loop, you can leave the ends hanging down or fray them, the choice is yours.

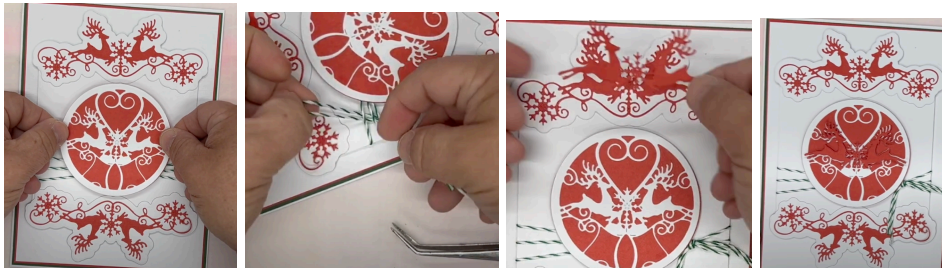

- Finally using the 'Separate Leaping Stags' die no 6, cut this out of Christmas Red card, we will add this onto the middle of our card using a little bit of Pinflair, but you could if you wanted cut 2 of them and layer them up on the top and bottom stags, the choice is yours.



Your card is now complete, I hope you have enjoyed these instructions.