

## JND361 Hathersage - by John Lockwood

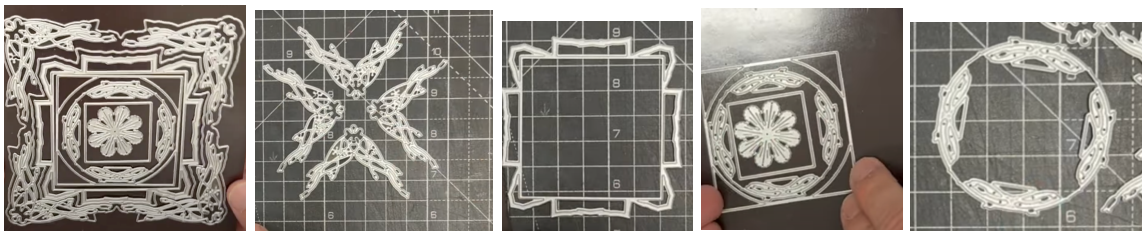

Instructions by June Smith

John has created a 'You Tube Video' dated 14<sup>th</sup> January 2024, using the new JND361 Hathersage Die set, where he demonstrates how to make a card. I would advise that you visit it as well as following these instructions.



**June's Tips:** This applies to any die, place your pieces onto your cutting plate at an angle, this helps to cut the dies in one pass. Also use your glue eraser to remove any unwanted marks.

### Information:

John call's these sets 'Concept' dies, so you have the following:

- 1) Outside Cutting Edge
- 2) Inside Cutting Edge
- 3-6) Four Separate Corner dies which fit inside dies 1 & 2 when cut together, they can also be put back-to-back to make 2 beautiful birds kissing each other, well that is what it looks like to me. There are so many patterns you can make with this set. They will also fit on an inch frame.
- 7) A central die which cuts out a beautiful plaque.
- 8) A square which has a die cut circle corner shape.
- 9) Circle patterned die which matches/compliments the 4 outside corners.
- 10) A Square cutting die.
- 11) Finally, a Marigold flower (which works with the Marigold flower set released by John last Year.

### Materials

7½" x 7½" White Top Folding Card Blank

JND361 Hathersage Die Set (11)  
 JND New Sentiment Stamp Set  
 Presscut Plain Squares Die Set PCD204(32)  
 Presscut Stitched Dot Squares Die Set PCD205 (16)  
 Essential Black Card  
 Essential White Card  
 A5 Die Cutting Machine  
 White & Black Pearls various sizes  
 Glue Glaze  
 2mm Foam Tape  
 Craft Kit

**Method:**

- Cut 2 pieces of Black card to 6" x 6". Then cut a White piece to 5 $\frac{7}{8}$ " x 5 $\frac{7}{8}$ ", position this onto the black. From the 2<sup>nd</sup> black piece cut out the outer die to make a black frame, we will be using this black frame on another project but first we want to use it as a template. So, take the 3 pieces of card and make sure they are exactly even on your table, then using some of the repositionable tape, tape them down along the top and bottom.
- From an offcut of the black card cut out the 4 corners. We then want to use glue glaze on the back of the 4 black corners and add these back inside the frame on the white piece, so they are even all the way around. You can then lift off the black from to see the white underneath with the 4 black corners in the correct position.

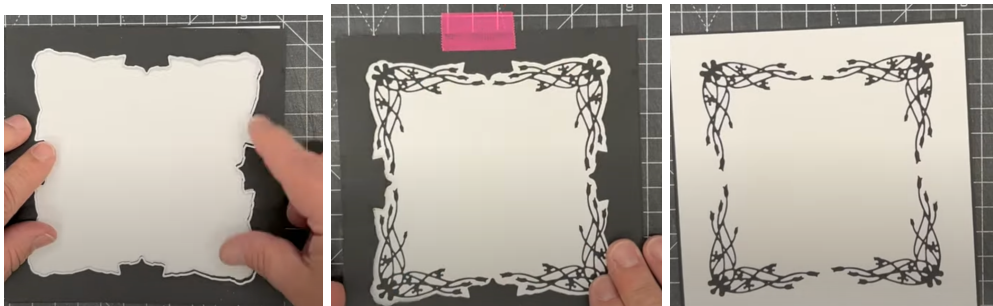

- From black card cut out die no. 7, add foam tape onto the back and adhere into the centre of your card.
- Then using a piece of white card and your stamping platform or a stamping block, stamp out your sentiment. Then cut the sentiment out with die no 8, before removing the die, take a pair of scissors or you guillotine and cut out around the outside of the square to produce a beautiful framed sentiment.

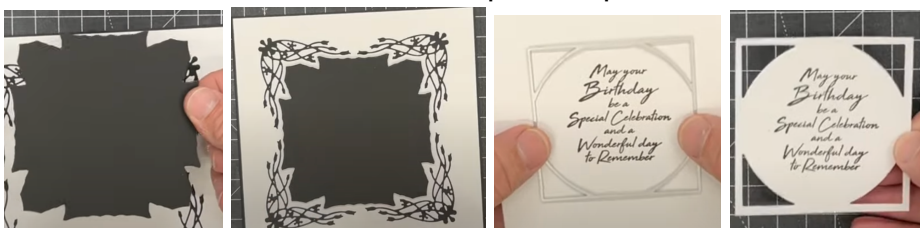

- Cut a piece of black card the same size as the outside of this square die. Add wet glue onto the back of the white square frame and the circle and add the

black square behind it. Then add foam tape onto the back and adhere straight onto the front of your card.



- Take 4 of the CA White Pearls and pop one onto each of the 4 corners, and if you notice there are smaller flowers either side of the corner flowers, so add one of the smaller pearls onto the front of these flowers.
- You could then add this straight onto a card blank, however we can make a 7¼" x 7¼" frame using the Presscut squares and stitched dot squares in White with a black front square, add foam tape around the back and add this onto your card front. Then from an offcut of white card cut out just 2 of the corner dies, add glue glaze onto the back and adhere these onto the black frame. Add some small black pearls onto them.



- Add wet glue onto the back and adhere the whole card onto a 7½" x 7½" white top folding card blank. It is easy to trim down an 8" x 8" card blank.



Your creation is now complete. I hope you have enjoyed these instructions.