

JND432 – Spring Wreath - by John Lockwood



Instructions by June Smith

John has created a 'You Tube Video' dated 27th February 2024, using the new JND432 Spring Wreath Die set, where he demonstrates how to make a card. I would advise that you visit it as well as following these instructions.



June's Tips: This applies to any die, place your pieces onto your cutting plate at an angle, this helps to cut the dies in one pass. Also use your glue eraser to remove any unwanted marks.

Information:

There are 12 dies in this new set and many of you will notice that die no 4 is a beautiful wreath, this is the same design as the wreath in the Christmas collection, but this one is slightly bigger. The largest outside circle die in the set will all fit on a 5"x5", 6"x6" & 7"x7" etc. card blank.

Die 1 – Plain Cutting Circle Die

Die 2 – Stitched Circle Die

Die 3 – Plain Circle Die

Die 4 – Wreath Die

Die 5 – Solid Heart Leaf facing Right

Die 6 – Solid Heart Leaf facing Left

Die 7 – 10, these are Framed Heart Leaves 2 facing right and 2 facing left

Die 11 – Stitched double ended Banner

Die 12 – There are twelve Small Daisies of various sizes

Materials

7" x 7" White Top Folding Card Blank

JND432 – Spring Wreath (12)

Essential Coconut White Card

Essential Spring Yellow Card

Essential Apple Green Card

Essential Field Green Card

Sage Green Card

A5 Die Cutting Machine

Pinflair

Stamping Press

Stamp 'With love always' onto a scrap of Coconut White Card

White Pearl Dimension

2mm Foam Tape

Craft Kit

Method:

- John has already prepared a card blank, using the Nellie Snellen Clover Square stamp, using the Sunlight, Coral & Flamingo Pearl Fusion Inks – and to match that for the flowers, he has just taken a piece of Coconut White Essential card and added the same Fusion inks onto it, then cut out the daisy plate from the Spring Wreath die set.



- Take a piece of Coconut White card cut to 4" square, add die no 4 – Wreath onto it, tape it down and run through your die cutting machine. **Tip** always make sure that your cutting plate is clean of all remaining die cuts, otherwise when you run the die and card through your machine the imprint of the waste pieces will show through. When the die has cut you will notice that there are no release holes to take the wreath out, the reason is that they're too fine and it warps the wreath when you take it out. There are release holes in the die to take all the unwanted pieces out, then to take the die itself out you simply tap it onto your table top and the die cut will then just release out of the die which maintains its integrity which is what we want it to do. We also need to cut it out of the matching yellow.
- Cut out from Coconut White Card, dies 1 and 2 together to cut a stitched circle.
- Then using the premade stamped square card, cut out the centre using the Plain Circle and foam mount that over the piece we have cut out so the colour matches.

- To stick this down we are going to use Pinflair glue gel as we want this to stand nice and 3D. You can of course use foam pads if you want to, but, because the wreath is quite delicate they will show through the slits. We will start by turning the yellow wreath over onto your table top so you are looking at the back of the yellow, then using a cocktail stick (or similar) take a little bit of the gel and add onto the wreath, when this dries you will not be able to see it. Place this onto the middle of the circle giving it a gentle tap down (don't squash it). Then repeat offsetting the white wreath over the top. If you used Autumnal colours like Craft Artist Christmas Green and Chocolate you would get a really festive wreath. Do it in some dark card and add some Christmas flowers on, you can do a lot of different things with this one.

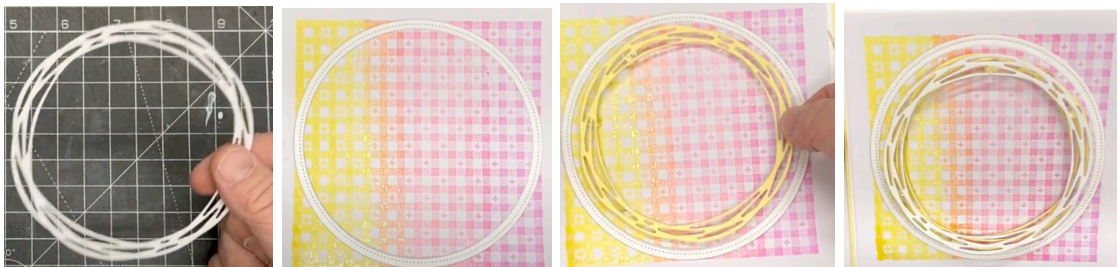

- In the die set you get 6 of the heart shaped leaves, 2 solid and 4 filigree, we will only be using the solid leaves. Cut them out of a mixture of light green and a darker green. Then add a little bit of Craft Artist Super Tacky Glue onto your table top or silicone mat, then starting with the darker green, dip the stalk end into the glue and very gently add around the wreath, remember the gel is a little bit damp. Add 3 of the leaves in the usual triangle corner shape, then add 2 of the lighter green onto them, (you can arrange them any way you choose). Then add just 2 lighter green in the opposite corner and one of the darker green on the top.

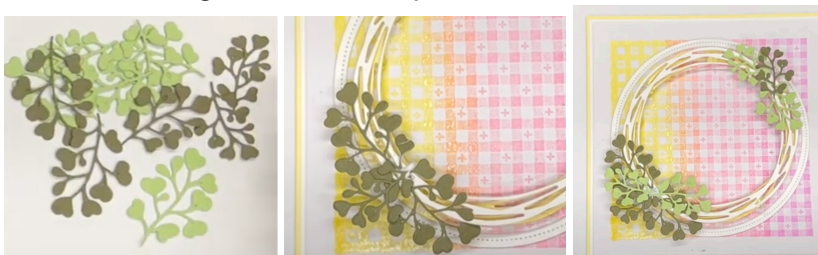

- Take the Fusion Ink Daisy pieces you made earlier and lay them out in size order onto your moulding mat and using a ball tool just go around a couple of times to bring up the petals. Using a pair of pointed tweezers pick up a flower and dip it onto the wet glue (you only want a little but) then add this over the leaves, repeat about 8 or 9 times then add 3 in the other corner over the leaves.
- Take some white Pearl Dimension and add a little drop into the middle of each daisy, and a few dots onto some of the leaves, to give them depth and dimension also around the wreath moving the card around not the pearl dimension.
- From a scrap of the Coconut White card using your stamping press and Versafine Smokey Grey ink pad, stamp the sentiment stamp 'With love always' along it, you could use a stamping block if that is easier. Then using

die 11 which is the banner, cut this out of the stamped White and also a scrap of the Yellow card. Then take a pair of scissors and cut the yellow banner in half, take the white banner, and dip the end into the glue and offset it onto the yellow so it is just popping through, then repeat this on the other end. Hold it for just a little while before you mould the banner in the middle with your fingers. Turn it over and add 2 blobs of Pinflair on top of each other going across the middle of the banner and just a little dab of Pinflair onto each end. Add this across the middle of the wreath. I would advise leaving this overnight to let the Pinflair set.



Your creation is now complete. I hope you have enjoyed these instructions.