

JND445 Tempus Fugit - by John Lockwood



Instructions by June Smith:

John has created a 'You Tube Video' dated 18th April 2024, using the new JND445 Tempus Fugit Die set, which is Latin for Time Flies, where he demonstrates how to make a card. I would advise that you visit it as well as following these instructions.

Information:

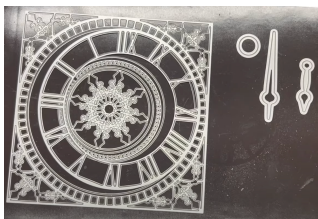

Die 1 – 6” Outside Big Ben Style with corner patterns and a circle of tiny squares.

Die 2 – Plain 5¼” Circle Die

Die 3 – Clock Roman Numeral Circle

Die 4 – Plain Inside Cutting Circle

Die 5 – Smaller Circle of Tiny Squares

Die 6 – Plain Smaller Circle Die

Die 7 – Stunning Centre Piece

Die 8 – Circle Stopper

Die 9 – Minute Hand

Die 10 - Hour Hand

Materials

8” x 8” White Top Folding Card

JND445 Tempus Fugit Die Set (10)

Vintage Copper Satin Card

Essential Black Card

Essential Coconut White Card

Die Cutting Machine

CA Black Pearls various sizes

Glue Glaze

2mm Foam Tape

Craft Kit

Method:

- Cut a piece of Vintage Copper Satin card to 7" x 7", place die no 1 centrally on it, which will give you a nice ¼" border all the way around. Also place die no 2 the plain circle which will give us the aperture, tape them down and cut out.
- Then cut a piece of Black card to 6¾" x 6¾", tape down die no 2 the 5¼ plain circle into the middle and cut that out. You can then use spray glue or wet glue on the back & adhere over the black piece. Turn this over and add foam tape around the outside and a little bit into each of the corners. Put this to one side.

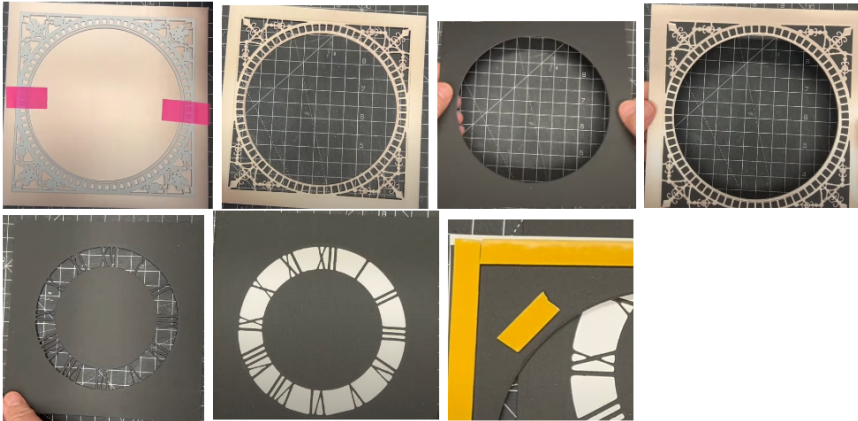

- Cut another piece of Black card to 6¾" x 6¾", we are going to cut the clock face on its own. Turn the die over and the best way to remember is that XII is 12 so it should be at the top, tape this down and cut it out. Then cut a piece of White card to 5¾" x 5¾", use spray glue or glue glaze to attach this to the back of the black clock face. Remember you get 2 piece of this size out of an A4 card.
- Bring back in the front panels with the 2mm tape behind, we will remove the yellow backing, add a few dabs of wet glue to stop the static & place over the clock face, it is VERY important that you get this in the correct position so use your grid board or similar to get the clock face even, you can then add it into position.
- Cut white card to 7¼" x 7¼", black at 7⅜" x 7⅜", & copper satin at 7½" and layer these up onto your 8" x 8" top folding card blank.
- Turn the clock over and add wet glue to the back of the square, then place this onto your layered card base, as we have put wet glue onto the back we can make sure it is central.



- Now we want to work on the centre, we already have a perfect circle of black & copper, take dies 4 & 5, also a long piece of pink tape, pick up die 4, the outside circle and add this over die 5 the tiny square patterned circle. Then

place in the middle of the black circle and cut this out. You then have a waste black circle for another project, and a beautiful patterned edge to your circle.

- We will now do the same principle of taking a long piece of pink tape, pick up picking up die 7 and add this over die 6 and cut this out. The waste circle can be layered onto the black circle for another project.



- We then cut out circle die no 6 from a waste piece of white card, this will go behind the middle copper circle. Then cut die no 4 from waste copper card and this will go behind the black pattern edge circle. Add glue behind the patterned front circle panels and add onto the plain circle backgrounds.
- From another scrap of black card, cut out both clock hands dies 9 & 10. Then from the copper cut out the centre circle die 8. We have now finished cutting all the pieces to make our clock.
- Add foam tape to the back of the black & copper circle and also the copper & white circle. Remove the yellow backing and add them onto the front of your card making sure that the copper points are in line with the no's: 3, 6, 9, & 12 (X11).
- We are now going to add our hands, the easiest way of doing this is take a little bit of foam tape, remove the yellow backing & drop it right into the centre. Then take the minute hand & add this into place, John has selected 8 minutes to 12, but of course you can add your one wherever you wish. Add a little bit of wet glue/glue glaze onto the centre of the black hand and add the hour hand. Then cut another tiny piece of foam tape, add this onto the back of the copper circle, remove the yellow backing and add into the middle of the hands.
- Finally, we take some of the CA Black Pearls and your glue glaze, to add a pearl onto the points in each corner, you can see in the photo below where they are. We then also add one around the middle of the clock face where the little points are.





Your creation is now complete. I hope you have enjoyed these instructions.

Below is a box frame with a working clock mechanism surrounded by the Scarlett Flowers & Dianthus leaves in complimentary colours, it is so beautiful.

