

JND462 – Deer Scene Tags – Card Project – 1 November 2024 - by John Lockwood



Instructions by June Smith

You Tube Video dated 1st November 2024, using JND462 – Deer Scene Tags die set, this has been designed to co-ordinate with JND463 – Tag Favour Box die set, this instruction is John demoing how to make this project. I would advise that you visit it as well as following these instructions.

Information:

JND462 – Deer Scene Tags has 12 dies, starting with the 4 tag dies:

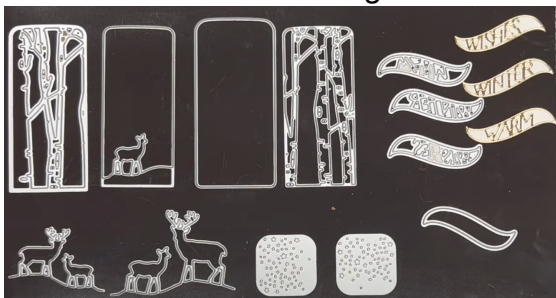

- 1 Tree in Tag (no outside cutting edge)
- 2 Smaller Tag with little Dow along the bottom on a hill (no outside cutting edge)
- 3 Large Tag cutting die to fit over dies 1, 2 & 4
- 4 Different trees in tag (no outside cutting edge)
- 5 With a medium size Deer and small Dow on a hill
- 6 With a Larger size Deer and smaller Dow on a hill
- 7 & 8 Rounded corner squares with beautiful star patterns which can be used as foiling dies as well.
- 9 Decorative Banner - Top "Wishes"
- 10 Decorative Banner - Middle "Winter"
- 11 Decorative Banner - Bottom "Warm"
- 12 Decorative Banner cutting outside die



Materials

6" x 8" Top Folding card blank
CA 2 in 1 Scoreboard & Tool Kit (CT9026)
JND462 – Deer Scene Tags (12)
JND463 – Tag Favour Box (6)
Essential Coconut White Card
Gold Card, Mirror or Satin, your choice
Craft Card or Essential Tea colour Card
Clear Acetate
CA Crystal Ice
Vellum
JND424 – 3D Embossing Folder - Snow Flurry
Die Cutting Machine
2mm Foam Tape
3M Craft Mount Permanent Spray Adhesive
Craft Kit

Method:

- Cut a piece of Coconut White Card to 5" x 7", we need to cut 3 panels into this, so take die no 3 and tape it down on the left side about ½" in (or a finger width), run this through your die cutting machine, then repeat from the right hand side, and finally again from the middle, this way you get the panels cut evenly across the card. We will use this as our Template.
- Then cut a piece of Craft card or Essential Tea Card to 4 $\frac{7}{8}$ " x 6 $\frac{7}{8}$ ". Place this onto your work surface add the white piece evenly over it and lifting carefully turn it back over to the front. We then take die no 1 and place this into the first panel and tape it down well with low tack tape, burnish it well, don't worry it will not tear the card. Then add die no 4 into the middle panel and finally die no 2 in the end panel. Then carefully remove the white template piece and add a long strip of tape along the bottom of the dies, then run through your die cutting machine. Pop the template on top and you can see the perfect die cut for our card.



- Cut a piece of Acetate to 4 $\frac{7}{8}$ " x 6 $\frac{7}{8}$ ", using spray glue onto the back of the Tea card and add the Acetate onto it evenly. Then add foam tape around the outside of the card. Also add foam tape onto the back of the template, remove the yellow backing and add onto the front of the card.



- Turn the card over so you are looking at the back and add some of the CA Crystal Ice inside. The cut a piece of Vellum to $4\frac{7}{8}$ " x $6\frac{7}{8}$ " and run this through your Snow Flurry embossing folder. Remove the yellow backing from the foam tape and add the embossed Vellum onto it. This is the point where we could finish the card, by adding another piece of the Tea card onto the back and add onto a card blank layered up with cream card – However we want to put some lights into this card.



- Bring in your battery powered lights, a lot of people tend to add hot glue when adding lights, but you can easily burn yourself doing it this way, so what we will do is to add 2 strips of blue powertape across the bottom of the Vellum and slightly over the foam tape. Take your pokey tool and remove the blue backing, then open your lights out, test that they work. Then with the battery pack hanging over the bottom of the right-hand side, begin to add the lights across the bottom of the powertape up to the left end just a little bit onto the foam, then fold the lights over and rung along to the right sticking the lights down as your go, repeat going backwards and forwards until you get to the end, on the left-hand side if you have any of the wire on the foam just fold it over onto the vellum. Turn your card over and turn on the lights, you will see that it looks like the sun is rising up along the bottom of the card. If you have any of the lights not showing you can turn the card over and rectify where the lights should be.
- Add another strip of foam tape along the bottom and around the outside of the frame. You will need a darker coloured card, John is using Craft card cut to $4\frac{7}{8}$ " x $6\frac{7}{8}$ ", you could use mirror or satin card if you preferred. Then when you turn the card over you have that dawn light showing through the apertures.



- Take your 6" x 8" Top Folding card blank and add a layer of gold mirror or satin card cut to 5 $\frac{7}{8}$ " x 6 $\frac{7}{8}$ ", and another layer of white card cut to 5 $\frac{3}{4}$ " x 6 $\frac{3}{4}$ " you have created your base card.
- Turn the card over and add wet glue around the outside and middle of the card and add this onto the prepared card blank. You may notice that the front of the card is a little bit sparse so let's add few more things to it.

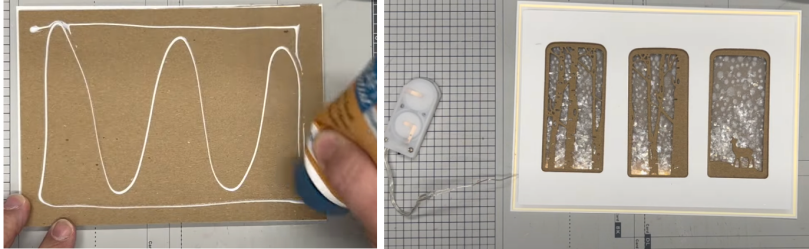

- Cut another piece of craft card to 7" x 3 $\frac{1}{2}$ ". Add die no 5 into the top right-hand side, see photo below, and run this through your die cutting machine.



- We want to add some scorelines, so if you are using the new 2 in 1 Scoreboard & Tool Kit (CT9026) mat, you can turn this over to the scorelines placing the card just under the black rule part, hopefully you can see this in the photo below. We are going to be scoring down from 40 to 38 and then going from to 36, or you could use a different scoreboard. Then take your scissors and finish the line either side, see photo below. Fold both of the score lines as valley folds. Add 3 strips of blue powertape, remove the backing, and add this onto the front of your card so that the bottom folds over, feed it around the bottom of the card and up, then stick this down so you have sealed all the layers from view at the bottom.

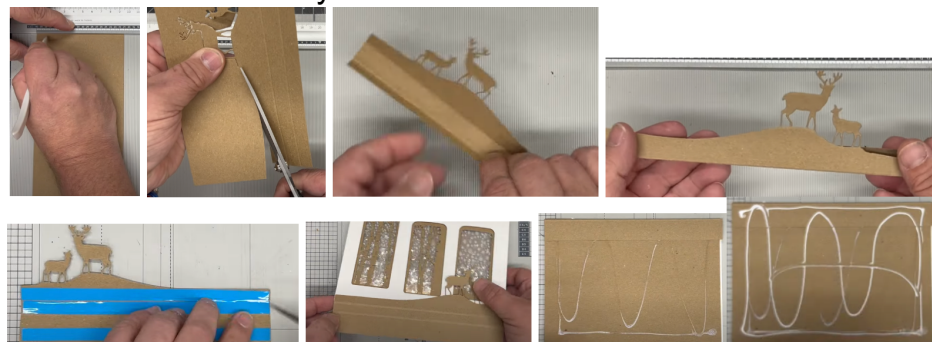

- Add more wet glue onto the back and add onto the prepared card blank. Open the card up and take your batter end, add a strip of blue powertape onto the battery making sure you can still open it up to change the battery if necessary, remove the blue powertape covering and add inside the card about 1" - 1 $\frac{1}{2}$ " in from the left of the card, the wire will then go over the top of the battery pack



- Then cut dies 9 (Winter), 10 (Warm) and 11 (Wishes) from gold mirror card, and using die 12 cut this out 3 times from white card. Add wet glue or spray glue to the back of the gold words and add onto the white. Turn the pieces over and using a little bit of Glue Glaze on the tips top and bottom, then add the words across each of the windows.



Your card is then complete, I hope you have enjoyed these instructions