

JND503 - Hopkins Notched Frame & Presscut Notched Rectangles Nesting dies - by John Lockwood



Instructions by June Smith

John has created a 'You Tube Video' dated 23 February 2025, where he demonstrates using the new JND503 Hopkins Notched frame and Presscut Notched Rectangles dies shown below, which is the latest release in the FrameMaker Series. I would advise that you visit it as well as following these instructions.

Information:

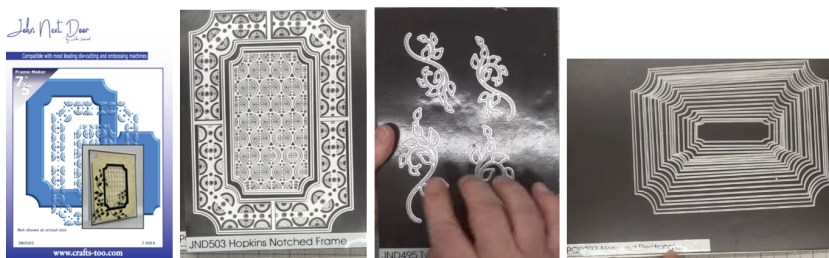

JND503 7" x 5" FrameMaker

Die 1 – Main FrameMaker Notched Corner 7" x 5" (It is a notched corner going into a notched corner giving you a 1" frame all the way round)

Die 2 – 5 are 4 decorative insert panels that fit inside the main frame.

Die 6 – Central notched corner die

Die 7 – Solid Decorative inside panel which complement the 4 corner panel dies which have a larger pattern in them

PCD223 Presscut Notched Rectangles Nesting dies

Materials

JND504 Charlies Notched Frame (9)

PCD226 Notched Rectangles (20)

Essential Coconut White Card

CATWARM Canvas Warm Tones –

CAT239 Lilac Card,

CAT240 Soft Pink Card

Wisteria Card

Canvas Neutrals – CAT234 Grey Card

Lilac and White striped Ribbon, (from the Art of Craft)

JND508 Handy Sentiment Stamps – Best Wishes
 VersaFine Smokey Grey Ink Pad
 JND495 Twisted Vines (4)
 A5 Die Cutting Machine
 CA Glue Dot
 CA Glue Glaze
 3M Spray Adhesive
 2mm Foam Tape
 3D Glue Gel in a syringe
 Craft Kit

Method:

- Take a piece of Coconut white card and tape down along the top of die no 1. Then add dies 2 – 5 evenly spaced into the frame and tape these down. Then run this through your standard A5 die cutting machine, we then have this beautiful frame with all the detail showing, there is a white inside panel which you need to put to one side as we will use this later. Then take die no 1 only and cut this out from a piece of Lilac card, this will go behind your white frame. These need to be glued together, you could use spray glue or wet glue if you prefer. Then add foam tape around the back.

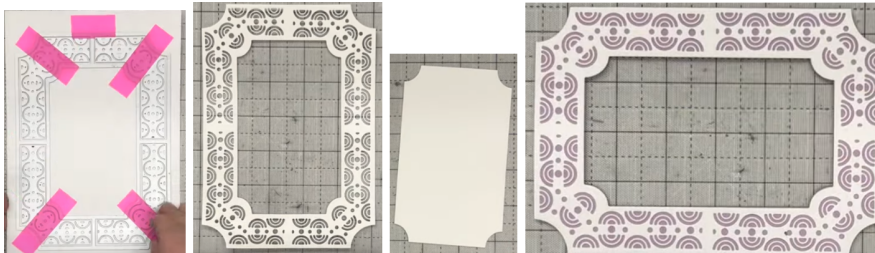

- Then bring in the Presscut Notched die no 5 which is slightly smaller than the main frame, or you could just cut a rectangle and cut the corners off. Then take no. no 6 Notched Frame and place this evenly in the middle, tape it down and run just the card and die through your die cutting machine. This will go behind the main frame, then finally take the white piece that we cut earlier, and tape down die no 7 evenly in the middle and run that through your die cutting machine.

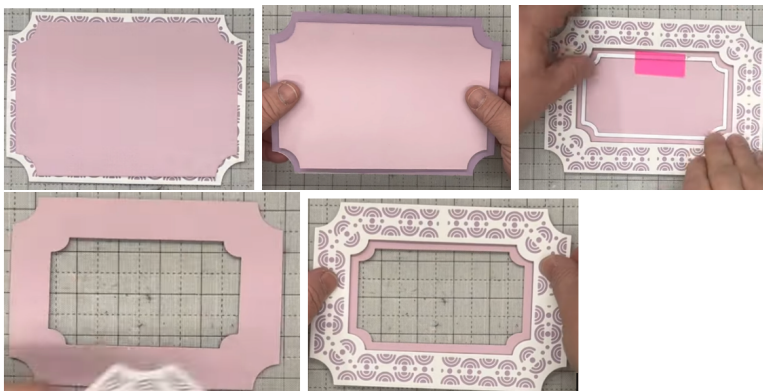

- Then bring back in the lilac inside cut left over piece, add spray glue onto the back of the white and add onto the lilac rectangle piece.

- We can now start to mount the pieces up, so take your soft pink piece which you have put foam tape onto the back, remove the yellow backing, and a few dabs of wet glue onto the foam, then add this onto the middle rectangle panel.
- Then bring back in your main frame, if you have not added foam tape around the back, then do this now, remove the yellow backing, add a few dabs of wet glue to stop the static and add this onto the pink layers.

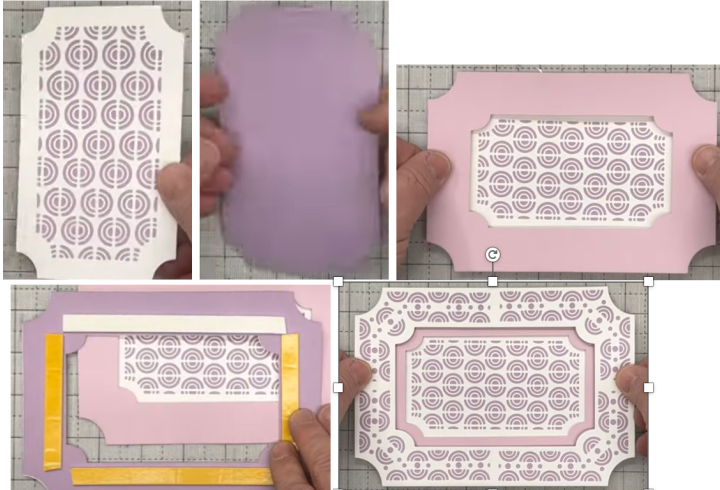

- We now want to create a card blank and a mat for this, so take an A4 piece of White card and fold this in half, then we need die no 2 from the Presscut dies, place this over the top edge evenly and then pull the die down so that the top cutting edge of the die is not going to cut the white card. onto the folded white card, tape it down well and burnish it, then run through your die cutting machine.

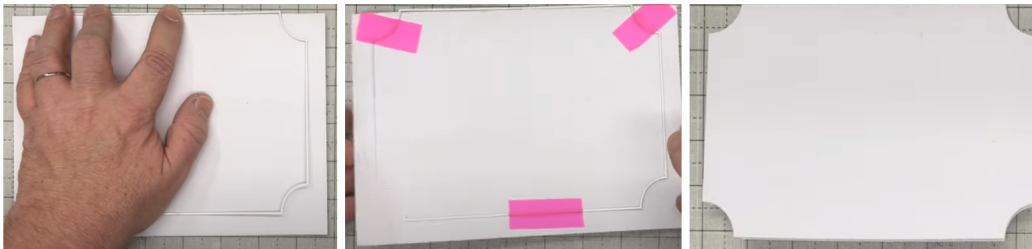

- Then from the same Presscut die, cut out a piece of the Grey neutral canvas card, this will fit perfectly over your card blank.



- We want to now work on just the main middle piece, bring in some of the lilac and white ribbon and fold it over the card, hold it in place and turn it over so you are looking at the back, you can then use your craft mat to get the ribbon even at the top and bottom. Add a strip of Sellotape onto the ribbon to secure it. Then add wet glue onto the back and adhere straight onto your card blank checking the fold is at the top and press down.

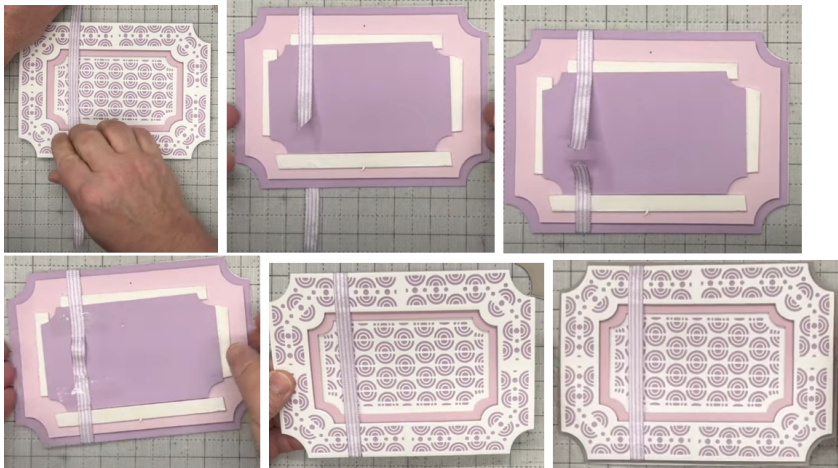

- Then take dies, 20, 19 & 18 which are the 3 smallest dies in the Presscut Notched Rectangles set and cut out from scraps of the (18) Grey, (19) Lilac & (20) White. Then on the smallest white piece stamp the Best Wishes into the centre using the VersaFine Smokey Grey Ink Pad. Layer up the 3 pieces using wet glue and then turn them over and add a strip of double sided tape to the back of the Grey, remove the yellow backing and tuck this just under your ribbon on the front of your card.

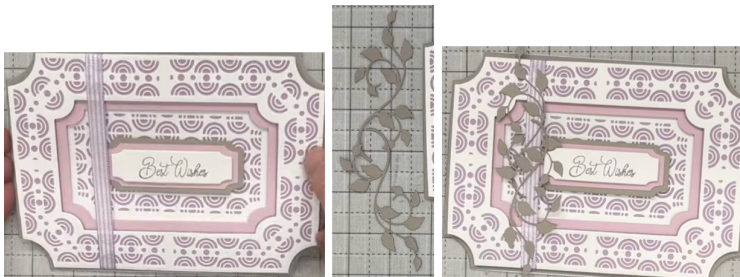

- Then cut out just to 2 largest Twisted Vines dies from a scrap of the Grey, add glue glaze onto the back of the leaves and a little bit on the stems and adhere onto your frame and ribbon, making sure that the vine do not hang over the top or bottom of the card.



- Bring back in your ribbon and create a double bow, turn this over and the best way to adhere this onto your card is to use a glue dot over the knot first then take your glue gel which you have put into a syringe and add a small dab either side of the knot, then add this onto your card.



Your creation is now complete. I hope you have enjoyed these instructions.