

JND514 - Toscana Edgers Lace Effect Card – Slimline Dies - by John Lockwood



Instructions by June Smith

John has created a 'You Tube Video' dated 2 May 2025, using the new JND514 – Toscana Edgers Lace Effect Card, these are the new Slimline Die set, where he demonstrates how to make a card. I would advise that you visit it as well as following these instructions.

Information:



Materials

- 6" x 6" White Card Blank
- JND514 – Toscana Edger Lace (4)
- JND523 – Leaf Sprigs (4)
- JND524 – Belinda Flower
- Essential Coconut White Card
- Canvas Card – Dark Pink
- Canvas Card – Green
- Crafts Too – Mini Die Cutting Machine.
- 3M Craft Mount Adhesive Spray
- Glue Glaze
- 2mm Foam Tape
- Craft Kit

Method:

- Cut a piece of Coconut white card to 5" x 2½" and also a piece of Canvas card in the darker Pink. Then working on the white piece, take the last 2 dies on John's magnetic sheet below and add them together until they meet across the top, it has a crinkly edge, tape them down at both ends and place right up to the very top edge of the white card, tape it down, then run through your mini die cutting machine. Then turn the die cut around so the pattern is at the bottom and repeat. Then add foam tape onto the back of the white and adhere onto the dark pink card, you can see the beautiful pink colour showing through the little holes.

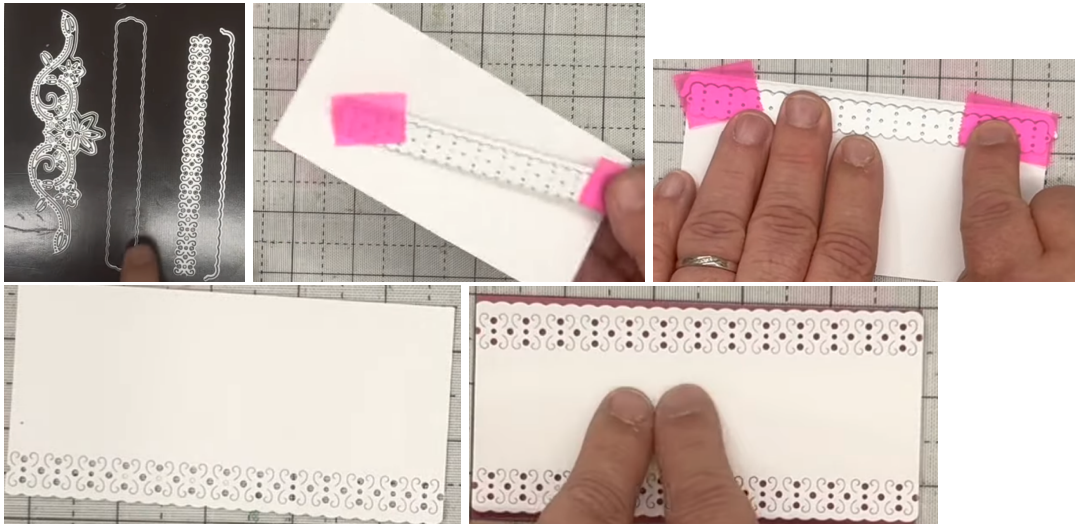

- Take a scrap of Coconut white card which measure about 6" long x ¾" wide. Then place the outside cutting die onto your mat, matching up the straight line right edge and add the decorative die inside, tape down across the top and bottom and also add another piece over the length of the die. Then run through your mini die cutting machine. We then need to take a scrap of the dark pink card and die cut the outside frame strip only. Then for speed John is using 3M Self Adhesive Display Mount but you could use wet glue or glue glaze. Add the white strip onto the dark pink. Add foam tape onto the back and place your main panel evenly on your mat and adhere down the centre.



- Add wet glue onto the back and using your multi-media mat adhere ½" in from the left of a 5" x 5" Coconut white card, adhere foam tape onto the back
- Then take a 6" x 6" and add a thin layer of Deep Pink and Coconut white card. Then adhere the main panel evenly onto it.
- John has already cut out a set of the leaf sprigs dies from green canvas card. Add glue glaze onto the back of one large and one small and adhere across the bottom corner of the main panel, the other leaf sprigs you can add to your stash for another card.

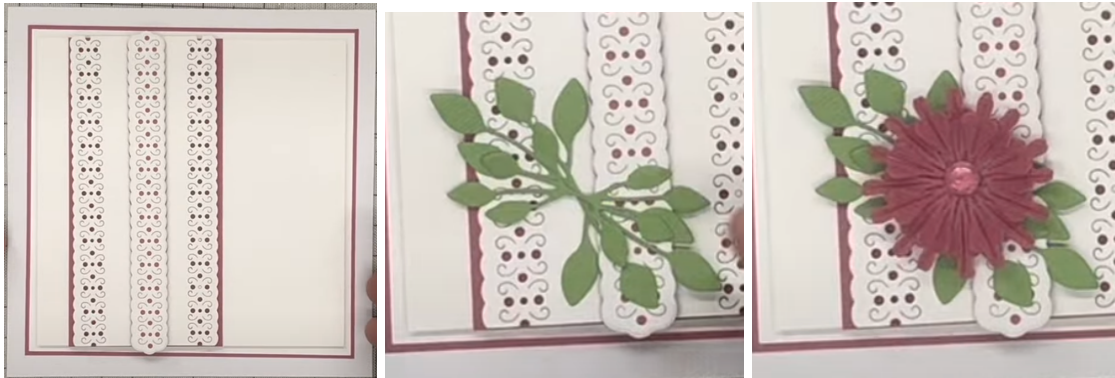

- Also, from The Belinda Flower Die John has made up a flower using the deep pink card with a clear dew drop in the centre. Take a cocktail stick and squeeze a little bit of Glue Gel onto it then use the cocktail stick as a handle to position over the leaves, hold it in place and remove the cocktail stick.



Your creation is now complete. I hope you have enjoyed these instructions.