

JND522 Florentine & JND524 Belinda Flower – Floral Swag Card - by John Lockwood



Instructions by June Smith

John has created a 'You Tube Video' dated 2nd May 2025, using the new JND522 Florentine and JND524 Belinda Flower, Slimline Die sets, where he demonstrates how to make a card. I would advise that you visit it as well as following these instructions.

Information:



We are going to make 2 cards today; one is using a standard or A5/A4 machine and the other is using our Mini Die Cutting Machine.

Materials

5" x 7" White Card Blank
JND522 Florentine Slimline Die set (3)
JND524 Belinda Flower die place.
Essential Coconut White Card
Canvas Summer Greens Pack
Canvas various shades of Red
A5 Die Cutting Machine
Mini Die Cutting Machine
Glue Glaze
2mm Foam Tape
Craft Kit

Method: Card One

- Cut a piece of Coconut white card to 4" x 6". Then place this evenly using the grid lines on your multi-media mat to place the die so the middle point is

pointing to the left, use the grid lines at the top and bottom to get the die straight and tape it down, then run this forwards and backwards through your standard A5 and upwards, die cutting machine. If any of the cut pieces are still in the card, use your 4-in-1 tool to poke them out.

- Then using wet glue add a 4" x 6" piece of the Canvas Moss Green card behind it. Add a strip of foam tape down each side.
- Cut a 4½" x 6½" layer of Moss Green card and using wet glue adhere onto it a 4¼" x 6¼" layer of Coconut White Card. Then you can remove the yellow backing from the foam tape and adhere the front piece evenly onto it.



- To decorate this, we are going to use up some small spare Red Flowers left over from another project. By looking at the Belinda Flower die plate you can see the really tiny flowers and we have some of these in different shades of canvas red left over from a previous project. These have a tiny white pearl in the centre of them.
- Add a dab of glue glaze just onto the swag swirly leaf pieces, then use your 4 in 1 pickup tool to pick up the flowers and add onto the glue glaze. Including the really tiny ones. They look as if they are growing out of the leaf swirls.



- Although John has not done it for this card, but you can if you wished, add a sentiment stamp across the bottom right of the card. That is using the larger version, so let's now make the smaller one.



Card No 2: The Smaller Version:

- Cut your card blank to 6½" x 3½" and put to one side.

- Cut a piece of Coconut White card to 3" x 6" and this time we know this will fit through the Mini Die Cutting Machine.
- Again, we are using the grid lines on our multi-media Mat to line up the card and place the die, again with the middle flower point pointing towards the left and tape in down top and bottom, then run forwards and back through your mini machine.

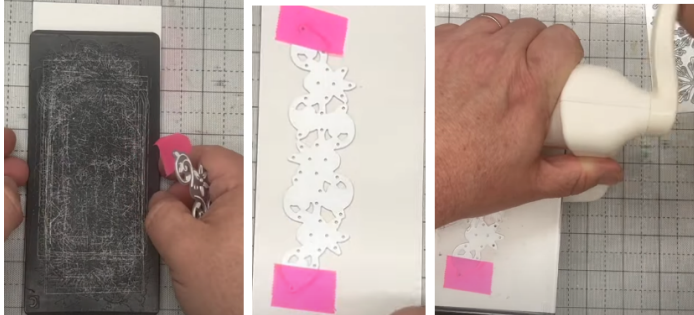

- Add wet glue onto the back and adhere this onto a 3" x 6" piece of the Moss Green card. Then turn the card over and add foam tape across the top, middle and bottom. Bring back in your prepared card blank. Remove the yellow backing and add onto the card blank.



- Then if you look at the pattern on the card you will see 3 flowers cut out, they have a small dot cut out on the right of the middle one and on the left of the other 2. We are going to use these as a marker to add glue glaze over the middle ones and add 3 tiny Belinda Flowers (in different shades of the red card) over the middle of the small dot. Then add glue glaze on the dot of the top and bottom flowers and add one of the die cut flowers onto each one. All the flowers have a tiny white pearl in the centre.



Your creations are now complete. I hope you have enjoyed these instructions.