

JND520 – Fold Out Centre Card – 4 July 2025 - by John Lockwood



Instructions by June Smith

John has created a 'You Tube Video' dated 4th July 2025, using the new JND520 Tapestry 5" x 5" FrameMaker Die set, where he demonstrates how to make a card. I would advise that you visit it as well as following these instructions.

Information:

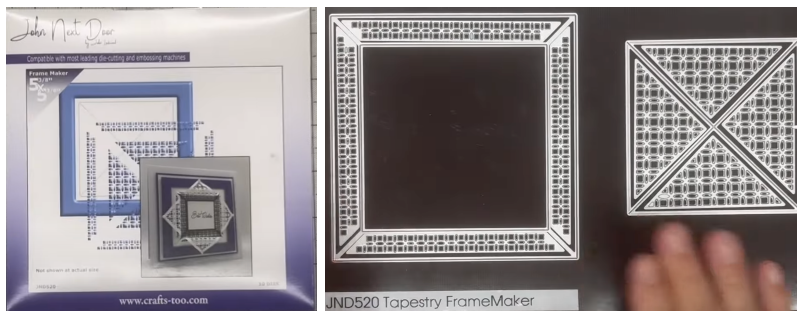

JND520 Tapestry 5" x 5" FrameMaker Die Set (10)

Die 1: Outside Frame 5 $\frac{3}{8}$ " x 5 $\frac{3}{8}$ "

Dies 2 – 5: Scallop Insert dies which fit into die no 1

Die 3: Square and Cross in the middle

Dies 4-7 Decorative looped triangles

The FrameMaker die in this set works perfectly onto a 6" x 6" card, die no 3 is a square die with a cross in the middle which is perfect for the card we are making today.

Materials

7" x 7" White Top Folding Card Blank

JND520 Tapestry 5" x 5" FrameMaker Die Set (10)

PCD204 Square Die set,

CTJJ260 Simple Poppies stamp set

Versafine Smokey Grey Ink pad

CT902 Precision stamp Block

Essential Coconut White Card

Canvas card Soft Blues pack – Mid Blue, Light Blue
 2 Flowers and leaves left over from another project.
 A5 Die Cutting Machine
 White Pearls
 Glue Glaze
 Glue Gel and Syringe
 2mm Foam Tape
 Craft Kit

Method:

- Take a piece of the canvas card in mid blue, tape down die no 1 which is the FrameMaker die and run through your die cutting machine.
- We then want to create our panels, so cut a $5\frac{3}{4}"$ x $5\frac{3}{4}"$ piece of the lighter blue from the canvas pack, if you position this over the mid blue square you can see that we get the perfect frame for our card. Take the 4 dies, no's: 2-5 in the set and tape down the first 2 dies edge to edge, then then 3rd, tape it down and finally the 4th and tape that down, so you have a square, tape that down and run through your die cutting machine.

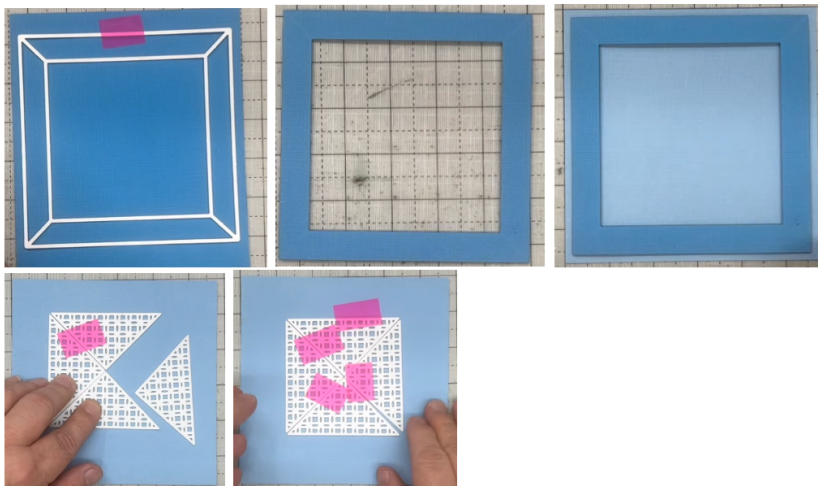

- This will then give you this piece below, John as already added the fall away piece from cutting the frame onto the back. You could just add the frame with a sentiment across it for another card, but we are not doing that today.

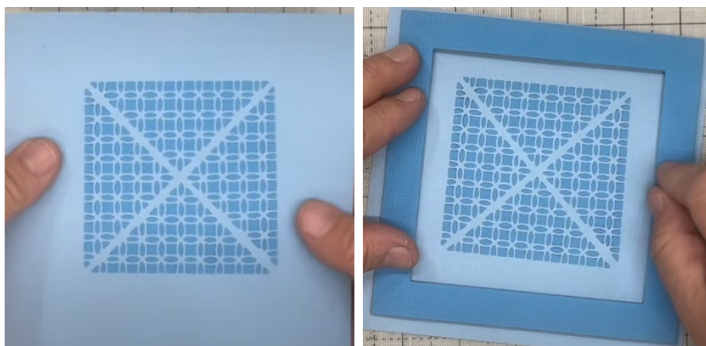

- Cut a piece of coconut white card to $5\frac{1}{8}"$ x $5\frac{1}{8}"$, lay onto your mat evenly, what we want to do is to place in the centre die no 3 which is the cutting square with a cutting cross in the middle, then add evenly and tape down the 4 decorative looped panels and run through your die cutting machine. You

then have this white piece below with the triangles loose in the middle. * **If you want to add the foam first.**

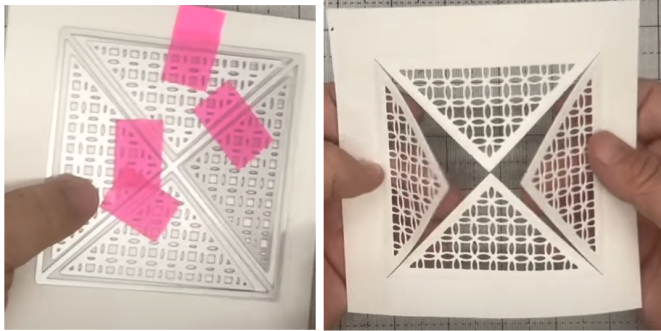

- To roll these, we want quite a large roll so use your 4 – in – 1 tool or similar to start from the point in the middle and roll this over the tool towards you, go backwards and forward to give it a good roll, turn the card around repeat on the other 3 sides.

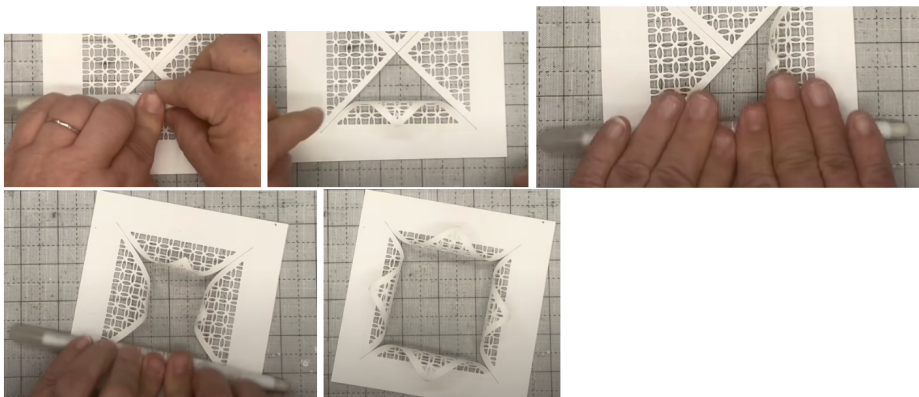

- Now we want to build our card, bring in the background piece and take some foam tape and add a strip on the back of the white rolled piece on all 4 sides, John said that you might find it easier to add the foam tape on before you curl the insides, so I have added an asterisk * **further up** if you want to try that way, it is up to you which you find easier. Remove the yellow backing and add onto your blue layer so that it is a perfect match with the corners, if you unroll one side and the point of the white is exactly on the point of the blue you know you are in the correct position and press down. We can then take our scissors and trim away the excess blue from the outside.

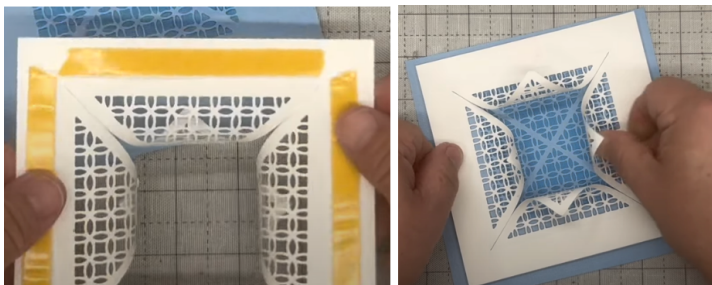

- Bring in your frame and add foam tape onto the back, remove the yellow backing and frame this over the card. What we then want to do is to pin the points onto the frame, so take a bit of the normal super tacky wet glue and add a small dab of it onto the outside the point, repeat for the other 3 points, you can then just smear the glue with your finger so we are reducing the amount of glue, wipe the glue off of your fingers with a cloth, then hold down

one of the points and sort of wiggle it a bit with your finger until it adheres onto the frame and then repeat for the other 3 points. I wonder if it would work with the glue glaze. Also, you might want to use a peg or bulldog clip to hold the point in place until it is dry.

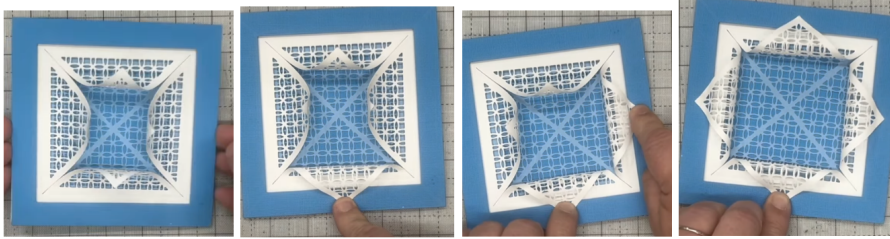

- Once the 4 points have stuck down, take the CA stick on white pearls and add one of the larger ones over the edge of the point, so that $\frac{3}{4}$ of the pearl is on the white point and the other $\frac{1}{4}$ is on the frame. Repeat on the other points.



- Then take your 7" x 7" top folding card blank, with a layer of the blue card and white onto it, then add wet glue onto the middle of the white square and adhere the main front piece onto it, and press down in the centre of the card, it is easier this way rather than adding the glue on the back of the main piece.

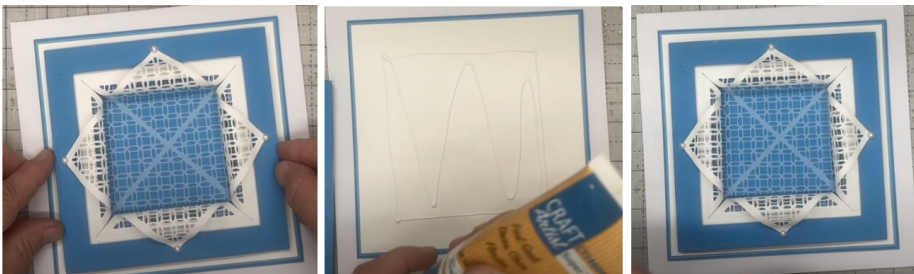

- Then using die 25 which is a 2" square cut this out of the blue card. We want to cut the white square using die 26 which is $1\frac{3}{4}$ " square but you may wish to stamp your sentiment onto it first using the smokey grey ink pad and the stamp, that way you know where to place the square die and cutting it out, the choice is yours which way you do it. Add foam tape onto the back off the blue and add this into the centre of your card.
- The sentiment John has used says: "You can never untie the knot of true friendship" which is absolutely perfect for this card.



- John has then got a couple of flowers left over from another project which have been cut from the lilac canvas card, and a couple of the green leaves again left over from another project. Add a dab of wet glue onto the back of the 2 leaves and adhere the stems coming out from the bottom left and top right corners just where the white folds start from.
- Then take a little bit of the 3d Glue Gel in a syringe and add a bit onto the back of each flower and adhere onto each of the stems of the leaves.



Your creation is now complete. I hope you have enjoyed these instructions.



Here is another sample made by Carol Bignall where she has rolled the insides outwards to give this very different effect.

