

## JND527 Mini Wreath Card – 27 July 2025 - by John Lockwood



Instructions by June Smith

John has created a 'You Tube Video' dated 27 July 2025, using the new JND527 Mini Circle Wreath Die set, where he demonstrates how to make a card. I would advise that you visit it as well as following these instructions.

### Information:



This Pink non shed glittery card has silver sparkle in it and when you move it around it gives such an amazing look, some of the colours may look slightly different on these instructions compared to the real life card.

### Materials

4" x 8 1/4" DL Card Blank  
JND527 Mini Circle Wreaths (9)  
JND385 Lesley's Bows (12)  
CA Non Shed Warm/Cool Tones Glitter Card Pack  
CTGFP-01 Blueish Silver Glitter Card  
Non Shed Silver Glitter Card  
Essential Coconut White Card  
A5 Die Cutting Machine  
3D Glue Gel and a syringe  
Arora Borealis Gems or Silver  
Glue Glaze

## 2mm Foam Tape Craft Kit

### Method:

- Cut your Non shed glitter piece down to DL size which is  $3\frac{1}{4}" \times 7\frac{1}{2}"$ . Then if you move the card up so it is about  $\frac{1}{4}"$  above the solid black line on your mat you can place the die into position and tape it down with Sellotape, (low tack tape will not stick to it) and run through your die cutting machine. tape down your larger inside circle die in the top third of the card. You can then see how beautifully it comes out, remove all the fall away pieces, which you can use to paper piece on another card. If you find that some of the little pieces don't want to fall out, there is a little trick for this, turn the card over and take your yellow glue eraser and rub this over the holes and all the pieces will come out. Use your brush to clean out the die, again keeping the pieces if you want.

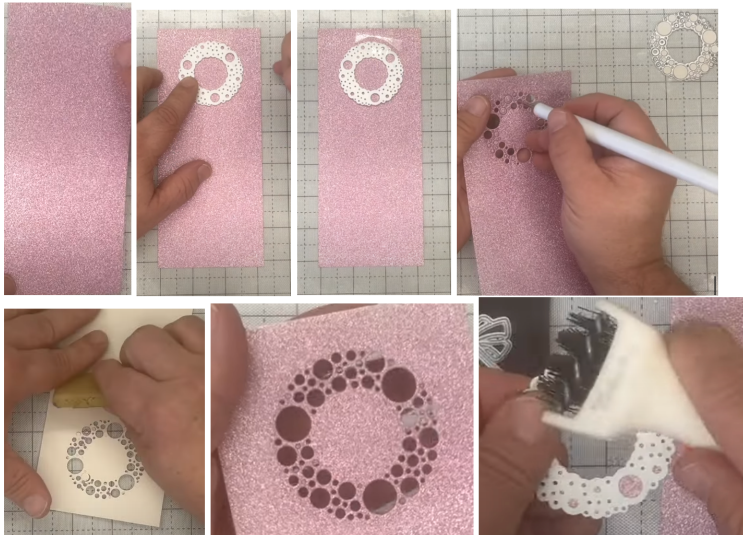

- Then tape the die down using the same spacing at the bottom as at the top, add Sellotape onto the die and run through your die cutting machine. Then repeat this process to cut the circle die out of the middle so you end up with the three very pretty circles cut out of your card.

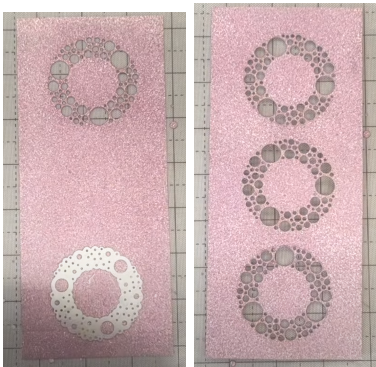

- Then turn the piece over and add foam around the outside and also in the middle of each circle for support. Then bring in your card base which is the longest piece of card you can make from an A3 Folded in half and add a layer of Coconut White and Blueish Silver Glitter Card, (this is almost like a Platinum or Titanium Bluish Silver colour).

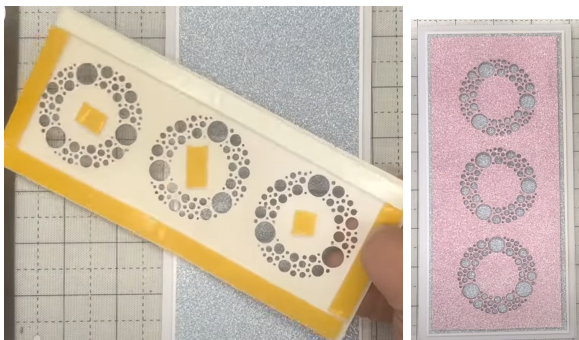

- Then we need to use one of the bows from Lesley's Bow set the bow die we are using is the debossed one from the set, tape this down onto a piece of the Silver Glitter card from the same set and cut out three bows in total.
- To attach the bows onto the glitter card we are going to use 3D Glue Gel in a Syringe to add a small blob onto the back of the bow and add onto the top of each wreath.

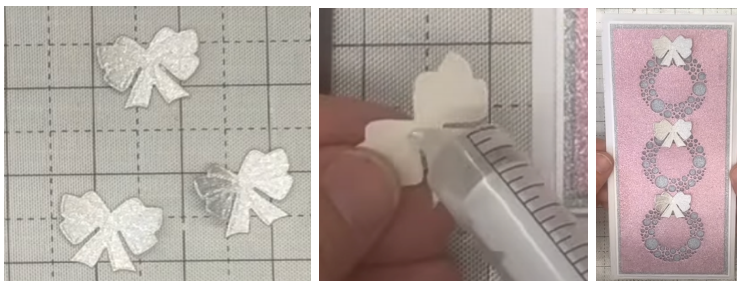

- Finally add an aurora borealis gem (or similar) into the centre of each bow



Your creation is now complete. I hope you have enjoyed these instructions.