

JND537 Snow Crystal Flower - Glitter Card -13 July 2025 - by John Lockwood



Instructions by June Smith

John has created a 'You Tube Video' dated 13th July 2025, using the new JND537 Snow Crystal Flower die set, where he demonstrates how to make a beautiful glittered card. I would advise that you visit it as well as following these instructions.

Information:



JND537 Snow Crystal Flower Die Set

Die 1: Outside Stitched Cutting Square Frame incorporating Stitched Circle in the centre size 5" x 5".

Die 2 - 5: Snowflake Corner Panels

Die 6: Inside Stitched Circle

Die 7 Snow Crystal Flower inside a Circle

Die 8: Narrow Frame matching the outside shape of the Snowflake

Die 9: Snow Crystal Flower framed in a cutting circle

Materials

7" x 7" White Top Folding Card Blank

JND532 Sweeping Boughs Slimline Dies (4)

JND537 Snow Crystal flower Die Set (9)

Essential Coconut White Card

Waterfall Glitter Card in Red

Waterfall Glitter Card in Gold

Tidy Tray or similar

CAT118 Crystal Snow

Die Cutting Machine

Crystal Gem

3M Permanent Spray Adhesive Display Mount

Glue Glaze
2mm Foam Tape
Craft Kit

Method:

- Take an A4 sheet of Coconut White card and cut down the short edge at to 5½", place this onto your mat, then place die no 1 which is an Outside Stitched Cutting Square Frame incorporating Stitched Circle in the centre and measuring size 5" x 5". Add a piece of repositionable tape just at the top so that the bottom of the tape doesn't touch the inside of the frame. Then take each of the inserts – dies 2 – 5, and tape these down with repositionable tape into the frame then run this through your die cutting machine.
- The take die number 1 again and add this to a piece of the Red Waterfall Glitter card and run that through your die cutting machine, as it is glitter card check the back to make sure it has cut, if not you may have to turn it around and run through again. You then get the perfect square with a circle cut out of it and the circle piece as well, not sure if we are going to use this circle piece on this card so keep in your stash box or you may be able to cut the flower out of it.
- To adhere the frame onto the waterfall card we are going to use spray glue onto the back of the white and adhere onto the red. Also, when you are adhering onto glitter no matter how good your spray glue is you always want to add ordinary wet glue through the dots on the die, so it doesn't peel away, it has a plastic coating on the non-shed glitter card, so you have to make sure that the layers are adhered properly.

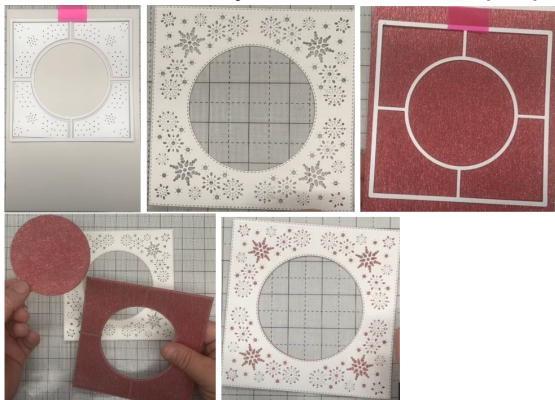

- John has got a tidy tray and opened his pot of the Crystal Snow, then holding the frame in the air run your wet glue up all 4 sides, it doesn't have to be neat or dead straight, the CA Super Tacky Glue dries clear anyway and the Crystal Snow is Chunky. Then holding the frame over your tray tip some of the Crystal Snow around all 4 sides, you need to set this to dry which usually takes 2-3 hours. Leave the piece on the side of the tray and when it is dry you can just brush any excess pieces off back into the tray then transfer it back into your pot, also do the same with the centre. It is a good idea to make up a few of these as I am sure you will make similar cards in the future. John has already made one up earlier



- Cut a piece of the Waterfall Glitter in Gold and cut this to 5" x 5", then take the next die down in the set with is no 6, a stitched circle and tape that down using Sellotape, into the middle of your card.
- Glue the gold square onto the back of your frame and add foam tape around the back.



- We then want to use die no: 7, which is a Snow Crystal Flower framed in a cutting circle and add this to a 5" x 5" square of coconut white card making sure that the flower petal is at the top, tape this down and run through your die cutting machine. John has made one of these earlier and already added a crystal gem into the middle.
- Then take die no 8 which is a narrow frame matching the outside shape of the Snowflake and cut this out of a small square of the Red Waterfall Glitter Card, remember to use Sellotape to secure it. This will give you the perfect snow crystal flower. We are going to add this onto the back of the card, the best thing to use for this is to use Glue Glaze adding a good bit into the middle and a dab onto each of the points of the petal top and bottom and running down the thin die of each petal. Take the Red flower, face down and hover over the middle and you will find that the petals only go one way, once you are happy press down to adhere it. Turn back over and press down on the front, you then have this beautiful red floating flower in the centre.

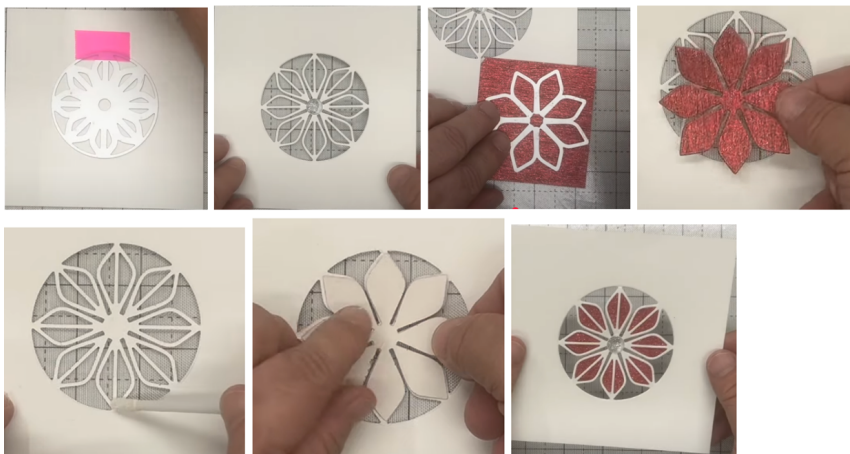

- We have used red and white so now we want to bring our design back to gold, cut this to 5" x 5". Then turn the white and red piece over and add foam tape around the outside and also trim a little square down and add that into the centre of the flower so it doesn't dip in the centre and add onto the gold. You could add acetate behind it to make it into a shaker card or add lights behind it, the possibilities are endless.



- Bring back in your frame and remove the yellow backing from the foam tape and add this straight over your flower, anything that you can see hanging out of the sides just take your scissors at an angle and cut them off.
- John has taken a 7" x 7" top folding card base and added a layer of the Red, Gold and Coconut White card onto it. Add quite a lot of wet glue to the back, more than you would use normally because of the weight, and add this onto your top folding card.
- From scraps of your Coconut White card cut out a set of the Sweeping Boughs, we only need 2 large and 1 small, add glue glaze to the back of the spine and adhere around the circle in the top right-hand corner. Then add 3D glue gel and a cocktail stick, or similar to add one of the largest flowers made up in Red and White with a silver gem in the middle

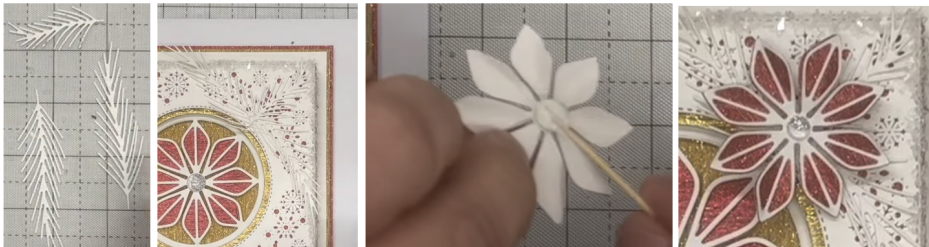

Your creation is now complete. I hope you have enjoyed these instructions.