

## JND539 – Insert Card - by John Lockwood



Instructions by June Smith

John has created a 'You Tube Video' dated 26 July 2025, using the new JND539 Festive FrameMaker Die set, where he demonstrates how to make a card. I would advise that you visit it as well as following these instructions

### Information:

The Festive FrameMaker frame die is 1" in depth. It also gives you this beautiful, perfect Stag embellishment. The FrameMaker in the set gives you a 5" x 1" deep frame, this is the first time John has created a die that is this depth and measurement before, this also works as the perfect frame to display your photographs. You will also need the JND528 Snow Crystal Flower Die set to make some fantastic flowers. These are coming back in stock, if you are wanting a set at the time of creating these instructions so keep an eye out for them.



### Materials

6½" x 6½" White Top Folding Card Blank

JND539 Festive FrameMaker Die (7)

JND532 Sweeping Boughs Die (4)

JND528 Snow Crystal Flower Die (8)

Rose Gold Glitter Card

Copper Colour Satin or Gloss Card

Arora Borealis Gems

Die Cutting Machine

Glue Glaze

3D Glue Gel and a cocktail stick

2mm Foam Tape

Craft Kit

### Method:

- Take your FrameMaker die and cut this out of the Rose gold glitter card. Then we want to use the 4 inserts on their own, take a 1" deep strip piece of Copper Satin card and take one of the insert frames, which fits exactly on the card, tape this down on both ends and run through your die cutting machine, we will need 3 of these that John has already cut out below, sorry about the glare on the photo.

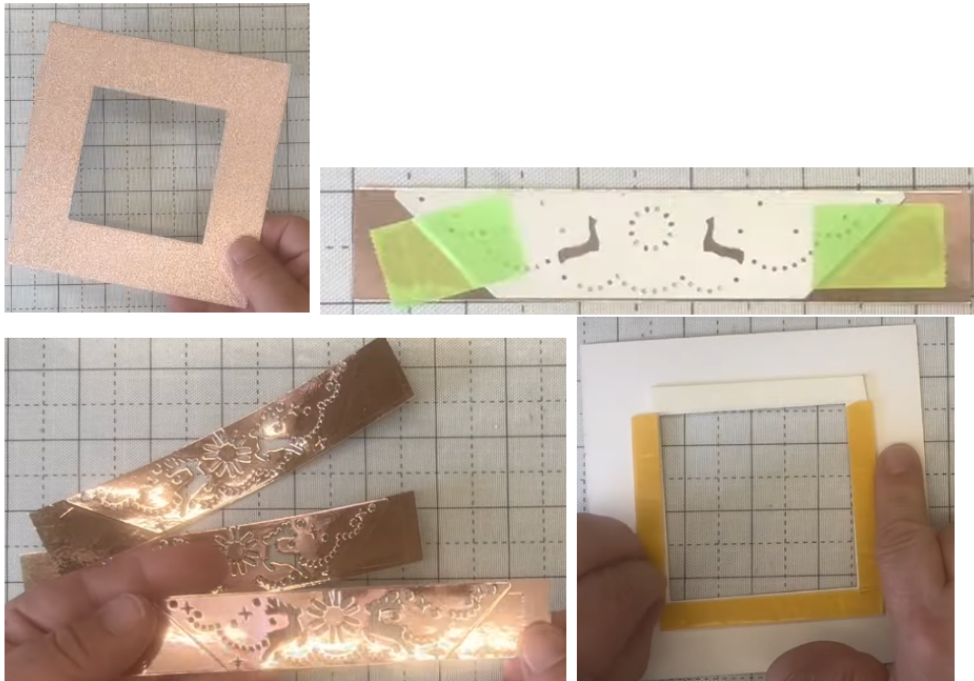

- Then turn your frame over and add foam tape onto the inside edge on all 4 sides. Remove the yellow backing and add one of the pre-cut inset frames and adhere so that the top is just under the bottom edge of the foam tape at the top, and the star in the centre of the stags is bang on in the centre, then stick onto the foam tape on both sides. We are going to do the same with the 2nd one, but this time add that at the bottom, so the bottom edge of the frame is just on the side of the foam tape. Then take the 3rd one and add that exactly into the middle so that the flower is aligned on all three pieces, but this one will overlap very slightly at the top and bottom. Then when you turn it over you can see how beautiful pattern is nice and straight and running down the centre. Then take your Titanium scissors and trim off the excess showing behind the frame on each side.

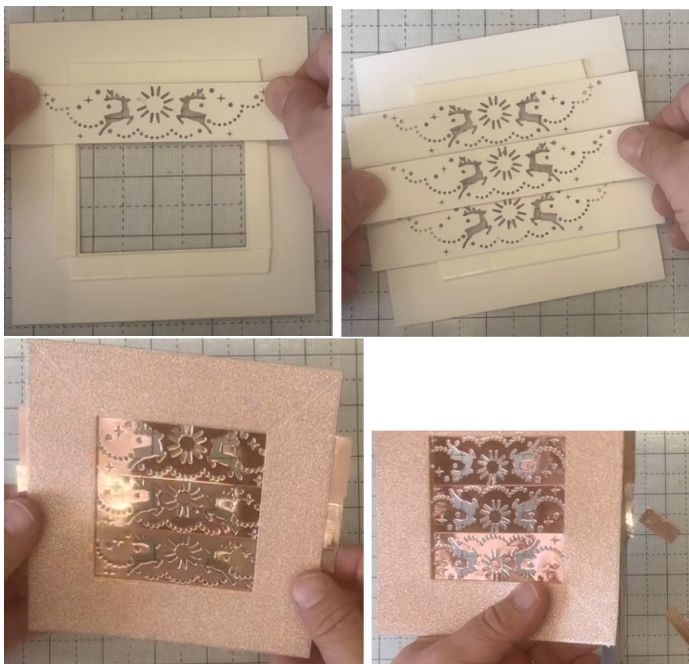

- John has already created the layers onto the 6½" x 6½" White Top Folding Card blank using a 5½" x 5½" square of Satin Copper and a 5" x 5" square of Rose Gold glitter card.
- Turn the frame over and add foam tape down both sides and over the top and bottom of the foam tape pieces. Then remove the yellow backing and frame this onto the front of the card.



- Using the Sweeping Boughs dies cut out 2 sets in white and 2 sets from the copper glitter card. Turn the white Boughs over and add a thin row of glue down the spine the of a large one and then add this on the top of the frame just slightly to the right. Then repeat this on the other one but this time add it just crossing over the end of the first one. Then repeat the gluing on the 2 smaller pieces and add them as you can see in the photo below.



- We are then going to bring in the Copper ones and add the 2 long and one short at an angle over the white ones, again using wet glue down the spine. Then add a long copper one on the bottom left of the frame, and another leading off from the right, then add wet glue to the 2 smaller white ones and



add these leading off from the middle where the large ones joined, so you are mix and matching the 2 sizes and 2 colours.



- John has then made up a set of flowers using the Snow Crystal Flower dies cut from the Satin Copper at the bottom and Rose Gold card on the outer side, all with an Arora Borealis Gem in the middle. He has also cut another set using the opposite layers.



- Then to finish off the card add an Arora Borealis Gem onto the centre flower of the 3 front panels.



Your creation is now complete. I hope you have enjoyed these instructions.