

## JND541 Black and Gold Robin Card – 18 July 2025 - by John Lockwood



Instructions by June Smith

John has created a 'You Tube Video' dated 18<sup>th</sup> July 2025, using the new JND541 Robin Die set, where he demonstrates how to make a card. I would advise that you visit it as well as following these instructions.

### Information:

The Robin Branch Slimline die can easily be made in about 15-30 minutes, and it is ideal to make a batch of these ready to be given or sent to the recipient. You could also make this into a stained glass window card by paper piecing the shapes back in with different colours. As you can see on the packaging you have an inside die and an outer die.



### Materials

5<sup>3</sup>/<sub>4</sub>" x 5<sup>3</sup>/<sub>4</sub>" Top Folding White Card Blank  
JND541 Robin Branch Slimline Die (3)  
Gold Waterfall Glitter Card  
Essential Coconut White Card  
Essential Black Card  
JND508 Handy Sentiment Stamps  
JND494 Hawthorn 3D Embossing Folder  
3mm Micron Pen  
3D Glue Gel & a Cocktail Stick  
Glue Glaze  
2mm Foam Tape

## Craft Kit

### Method:

- Take a scrap piece of Essential Black card which is about 6" x 4", and tape down the fine line Robin into the centre at an angle, this way when we cut the die out the waste can be used as a base for another project. Then take the larger solid Robin die and place this into the middle of a scrap of the Gold Waterfall card but this time because it is waterfall card we need to use Sellotape to tape the die down. Then as we did on a previous card, take your A4 cutting plate and add your metal shim onto it, then add the gold waterfall piece down onto it, the black piece doesn't need to go onto a metal plate, and run both of them through your die cutting machine. The dies are delicate so take your time removing the die cuts. You will notice that you get the head of the Robin, and it has a small hole in it, put this to one side for now. When you remove the waterfall gold piece you can see how you could add onto the black waste piece for a perfect offset for another card, so keep hold of them.

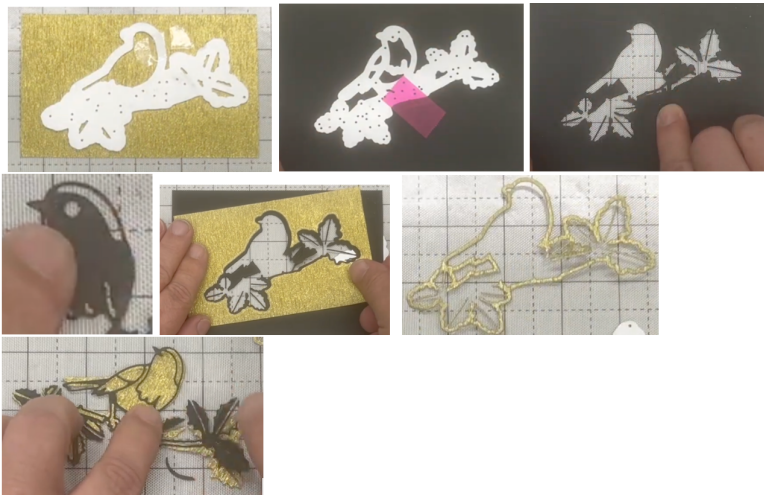

- Carefully remove the inside piece of the gold waterfall card, there are fall away pieces from this that you can keep to paper piece on another card.
- John has already adhered the black onto the gold using Glue Glaze . Then bring back in the black body of the Robin and place this over the top, then use a 3mm Micron Pen to draw inside the hole which makes his eye.

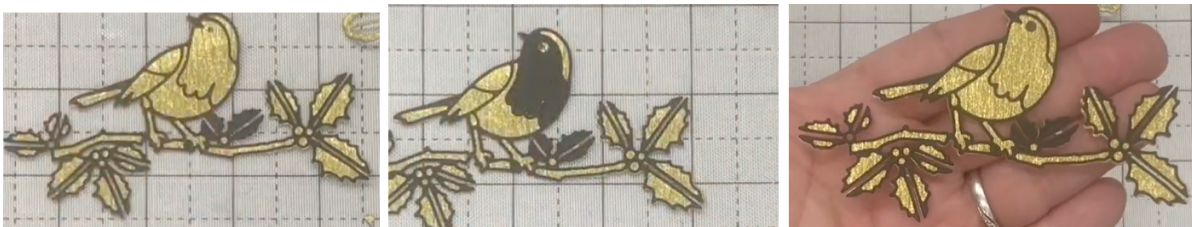

- Cut a piece of Coconut White card to 4 $\frac{3}{4}$ " x 4 $\frac{3}{4}$ ", lay this on your all purpose mat. Then take the 'Happy Christmas' stamp and place this evenly in the centre using the Precision Stamp Block, then ink up the stamp with your Versafine Black ink pad, then turn the block back over and using the lines on your mat to line it up the stamp, add along the bottom right hand corner then press down. As many of you know this is my most favourite stamping tool, it is a real game changer.

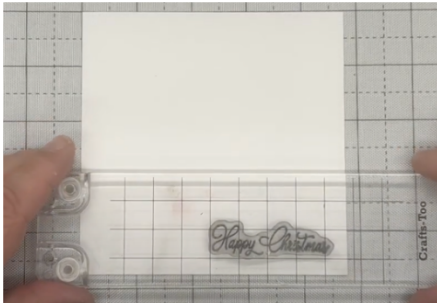

- We are then going to place the square evenly on all four sides into the 'Hawthorn' 3D Embossing folder, close the lid and run through your machine.
- John has already added the embossed piece onto a layer of the black card, Waterfall Gold card and another of Coconut White.

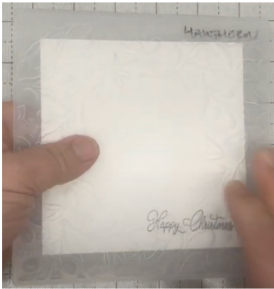

- Turn the Robin over and using the CA 3D Glue Gel and a Cocktail stick (or you could use a small syringe) to add a blob onto the Robins body, the head, the middle of the large holly and a small blob on the middle holly piece next to his legs.

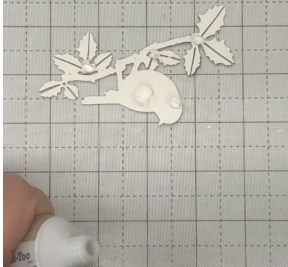

- Bring in your 5 $\frac{3}{4}$ " x 5 $\frac{3}{4}$ " Top Folding Card Blank, then add wet glue onto the back of your main card and adhere onto your top folding card blank.
- Finally Bring back in your Robin and position him at an angle across the front of the card.



Your creation is now complete. I hope you have enjoyed these instructions.