

JND525 & JND526 Square Panel Card – 6 September 2025 - by John Lockwood



Instructions by June Smith

John has created a 'You Tube Video' dated 6 September 2025, using the new JND525 Janes Panel Die and JND526 Mini Flower Plate Die, where he demonstrates how to make a card. It is ideal for using up your scraps. I would advise that you visit it as well as following these instructions.

Information:



Flowers: You get 8 large, 8 medium and 12 small, cut out of Canvas yellow card and from the lighter Canvas Lemon card you get the same number of dies, all have a small white pearl into the centre.

Materials:

8" x 8" Top Folding White Card
JND525 Janes Panel (2)
JND526 Mini Flower Plate
Canvas Card: - Mid Yellow and Light Yellow
Essential Coconut White Card
A5 Die Cutting Machine
Glue Glaze
2mm Foam Tape
Craft Kit

Method:

- Cut a piece of Coconut White card to 5 $\frac{3}{4}$ " x 8 $\frac{1}{4}$ " (the full length of the A4 card). Bring in the main die from Jane's Panel, and you can see that there is a sort of arch of flowers in the middle with more flowers either side. We want to place the die so that there are equal margins on all 3 sides then tape the die down and run this through your die cutting machine. Then poke all the die cut pieces out using your pokey tool. Then rotate the die and line it up underneath the first die cut, tape it down and run it through your die cutting machine. When you have poked all the waste pieces out your panel looks like the 3rd picture below.

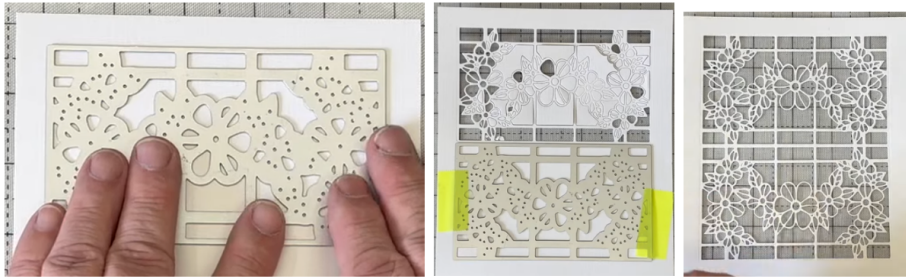

- Then cut some 1" strips of the Canvas card in sunshine yellow, and one strip which is $\frac{3}{4}$ " wide. Add spray glue onto the back of the white die cut, place it sticky side up onto your table and begin to add the strips into position. The narrow strip will go into the middle where the join of the die cut is. Turn it over and you can see this stunning die cut pattern on the front.

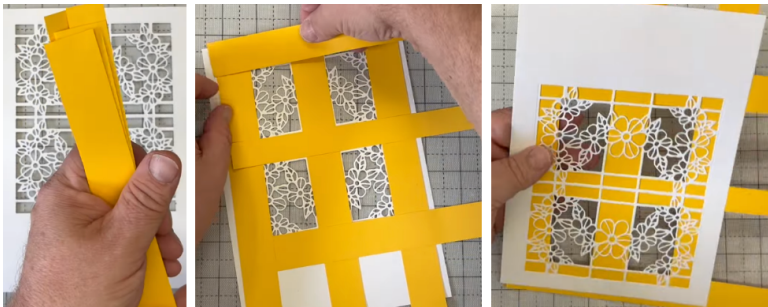

- Take your scissors and cut off the excess strips. Add spray glue onto the back, then cut a piece of the lighter spring yellow card the same size as the white and add this onto the strips, then when you turn it over you can see the beautiful patterns on the front. We are not doing this today but if you wanted to you could cut out the die from a different colour yellow and paper piece where the white shapes are. Or colour them in with your coloured pens.



Using the 7" FrameMaker and the 6 $\frac{3}{4}$ " FrameMaker dies, cut out a frame from the 2 shades of yellow, add foam tape onto the back, remove the yellow backing and add

this over the front of your card. Take your scissors and undercut any pieces of card that are hanging over.

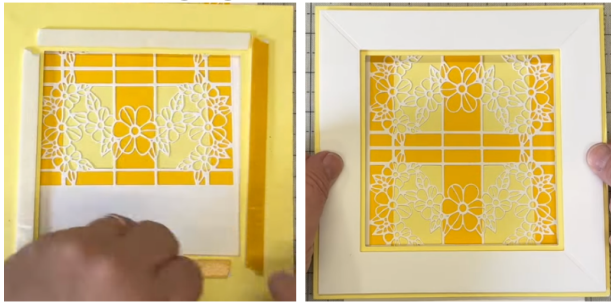

- Bring in your 8" x 8" Top folding card blank, add wet glue onto the back of the main card and adhere onto the card.

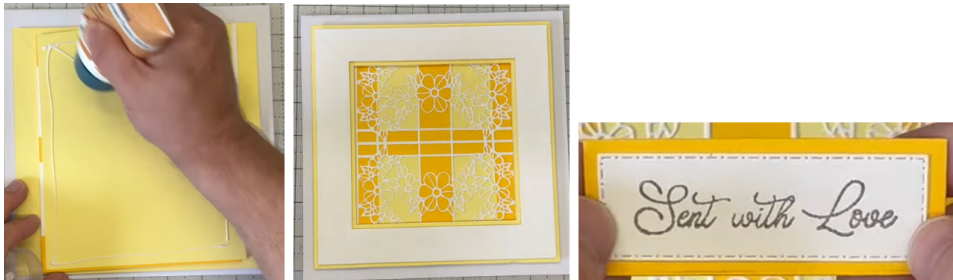

- Then using the Presscut Stitched Dot Rectangle and the Plain Rectangles and cut out from the yellow and white card. Using your Precision Stamping Block and the 'Sent with Love' stamp, ink the stamp up with Versafine Smokey Grey Ink and add onto the white rectangle. Then add foam tape onto the back and adhere this onto the front of your card.
- Then bring in your flowers. Add some of the Super Tacky Glue onto your mat and using your tweezers pick up a flower and dip the back into the glue and then add them randomly around both ends of the sentiment strip on the front of your card.

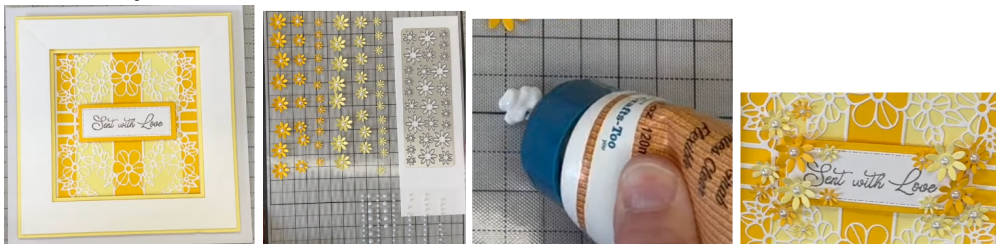

Your creation is now complete. I hope you have enjoyed these instructions.