

JND533 – White Poinsettia Frame Card - 27 September 2025 - by John Lockwood



Instructions by June Smith

John has created a 'You Tube Video' dated 27^h September 2025, using the new JND533 Slimline Poinsettia Die, JND576 Shooting Star Slimline Die, and the JND577 Circle Stars Die Set, where he demonstrates how to make a card. I would advise that you visit it as well as following these instructions

Information:

Today's card is a box card where we have this collection of really soft and subtle Slimline and Mini Poinsettias that just sparkle and shine and have a real beautiful look to it, and would work perfectly with a 'Thinking of you at Christmas', or 'Thoughts or Wishes' or something like that to make this really subtle card, which is made with the brand new JND533 Slimline Poinsettia die plate, and we've put them on with the JND576 Shooting Stars die plate and we are also using the outside frame from JND577 Circle Stars die set.

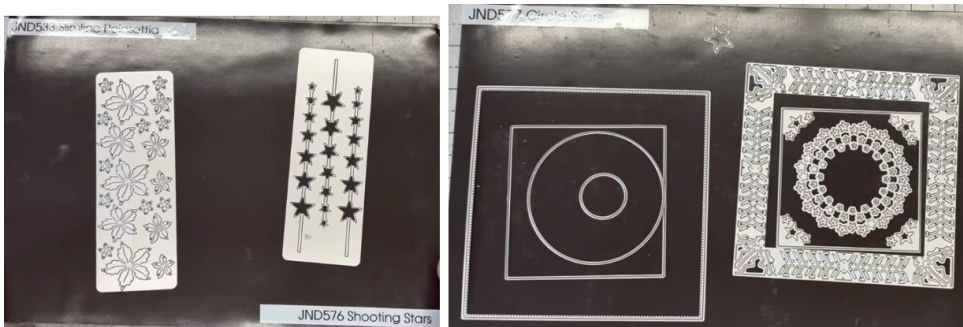

Materials

7" x 7" White Top Folding Card Blank
JND533 Slimline Poinsettia Die
JND576 Shooting Stars Slimline Die
JND577 Circle Stars Die Set
JND492 Retro Snowflakes 3D Embossing Folder

Essential Coconut White Card
 Silver Glitter Card
 CA Verdant Pearl Fusion Ink Pad and a handheld dauber
 Clear Small Crystals
 Die Cutting Machine
 3D Glue Gel with a cocktail stick or similar
 Glue Glaze
 2mm Foam Tape
 Craft Kit

Method:

- Cut a piece of Coconut White card to $5\frac{3}{4}" \times 5\frac{3}{4}"$ and take the centre plain square and decorative frame from the Circle Stars die set. Take a long piece of tape and pick up the square die, hover over the frame die until it is even and press the tape down, you then have 2 handles that you can use to place the dies into position in the centre of your white square, you should have $\frac{1}{4}"$ border all the way around, then run through your die cutting machine.
- You get this white frame below, John has already added some crystal gems into the 4 corners and also onto the centre top, bottom and both sides. Then turn the frame over and add foam tape around the outside, put to one side.

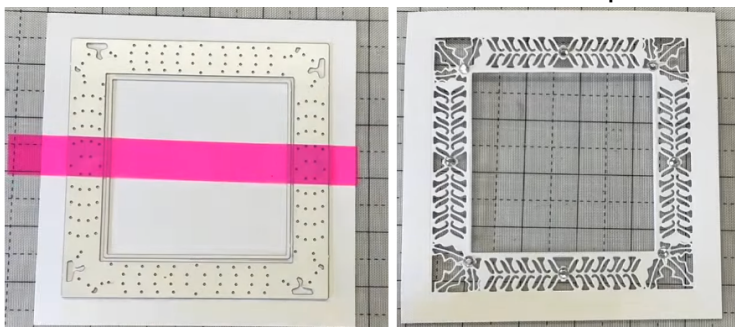

- Then cut a piece of Silver Glitter Card, or any colour you want and cut this to $5\frac{3}{4}" \times 5\frac{3}{4}"$ and add the same inside cutting die from the Circle Stars die set evenly into the middle and run this through your die cutting machine. This will give you this beautiful frame. Take your cut white frame, remove the yellow backing from the foam tape and add this evenly onto the glitter frame, you will see that it floats over the glitter frame and doesn't sink. Then add 5mm deep foam tape onto the back.

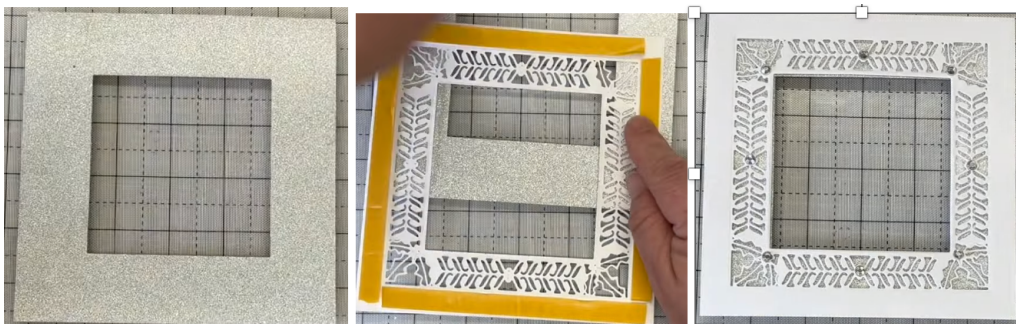

- Cut another piece of Coconut White card cut to $5\frac{3}{4}" \times 5\frac{3}{4}"$ and emboss this with the JND492 Retro Snowflakes 3D Embossing Folder, to get the perfect background for our frame. Bring in your frame and place this frame side down

onto your work surface, remove the yellow backing from the 5mm foam tape and add the embossed square onto it, if you don't have 5mm foam tape you could use a combination of 2mm & 3mm. As you can see on the photo below you get a much deeper, almost box frame which is perfect for putting your flowers and stars on.

- Bring in your 7" x 7" white top folding card blank and add a mat and layer of Silver Glitter card to 6½" x 6½" and Coconut white cut to 6⅝" x 6⅝" then add wet glue onto the back of the main card and adhere straight onto the card. Put this to one side as we work on our flowers.



- Take a scrap of Coconut White card which is 2¾" x 5¾" tall and tape down your Slimline Poinsettia die plate onto it and run through your die cutting machine. Then from a scrap of silver glitter card tape down the Shooting Stars die and run that through your die cutting machine. You can see below that John has already cut 2 sets of these out and added Verdant Pearl Fusion Ink onto the edges of one set of the Poinsettias, but he is showing us below how to colour the edges using a hand held dauber, it looks a bit like a pencil but with little foam pads either end.
- If you haven't got this A4 Multi Media Craft Mat it is great for placing your flower onto when you are working or even your dies.
- You get 3 large, 2 medium, 2 small and 10 of the mini Poinsettias.
- Then from the Stars you get 3 long dies that have 7 stars on each, which John has cut down to make 2 pieces that have 5 stars, 2 with just 2 stars on them and 1 with 3 stars on them, for this one he has cut a tiny snip into the side of the star to repoint the star. That way you get a perfect little spray of stars.



- To colour the edges of the flowers John is using what looks like a pencil with little foam pads on the ends, I think they are called handheld daubers and pick up some Verdant and colour just the centre of the Poinsettias. Then hold each Poinsettia in the air and using the dauber just flick around the edge of each petal and it gives you that beautiful white/green poinsettia which you find an awful lot in Spain. You can see that the design has a sort of a central

spine but that's a cut through which means that you can simply pinch upwards to shape each of the petals, then add a clear crystal into the centre.



- We now want to add our flowers and stars onto the card and to do this we are going to be using CA 3D Glue Gel with a cocktail stick, just squeeze a bit of the gel out and pick it up with the cocktail stick and add this blob into the middle of your card, then repeat to add another 2 blobs on top, you can use the cocktail stick to spread it around a little bit so you are almost creating a little bit of a tacky mess in the middle. Then take your stars and add these from the centre outwards as you can see in the photo below.



- Then John has added some of the 3D gel into a small syringe which is perfect for adding a small blob onto the back of your flower and adding them onto the card. Add the 3 largest Poinsettia into the middle and work these flowers outwards on the actual stars so they are floating as you can see below.

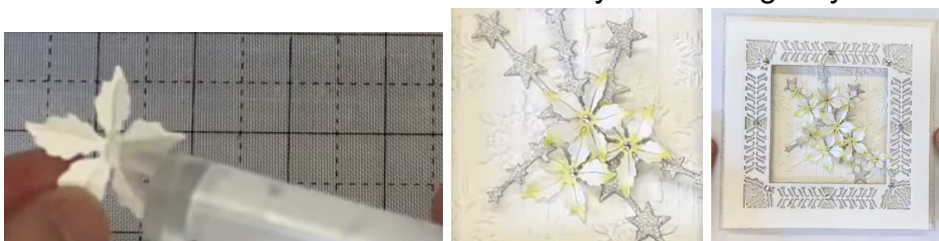

- Then to add the mini ones which also have a tiny gem in the centre, we can just add the glue glaze wand onto the end of a star or the embossed background and using your 4-in-1 pick up tool, pick up the flower and place this onto the star or onto the background. These are so difficult to see but if you compare the before and after photo it might help.



- Hopefully you can see below, the 'before' on the left and the 'after' on the right, just how beautiful these tiny flowers look on this stunning card.



Your creation is now complete. I hope you have enjoyed these instructions.