

## JND550 & JND551 Paper Pieced Card – 2 September 2025 - by John Lockwood



Instructions by June Smith

John has created a 'You Tube Video' dated 2nd September 2025, using the new JND551 Stitched Lines and JND550 Dotted Lines die sets, where he demonstrates how to make a beautiful Paper Pieced card. I would advise that you visit it as well as following these instructions.

### Information:

The two die sets work together to give us a perfect 6" x 4" FrameMaker. Which will fit perfectly onto a 6" x 4" or a 5" x 7" Card



### Materials

5½" x 7½" Top Folding Card Blank  
JND550 Dotted Lines Die  
JND551 Stitched Lines Die (6)  
Essential Coconut White Card  
Canvas Co-ordination Card – 2 different shades of Pinks  
JND510 Stitched Vine Leaves  
JND516 Dogwood Flower  
JND Double sided Adhesive  
2mm Foam Tape  
Craft Kit

### Method:

- We will start by using the Stitched FrameMaker die. Also, the Dotted FrameMaker die which gives a perfect 4" x 6" frame. Bring in a piece of the

Canvas Salmon Pink card, tape down the wider dotted FrameMaker die onto it and run that through your die cutting machine.

- Then take a piece of coconut white card and tape down the Stitched FrameMaker die, then run through your die cutting machine. Add foam tape onto the back of the salmon pink frame and adhere onto the white frame, then add a layer of foam tape onto the back. The outside white frame measures 4" x 6" and is perfect for adding to a 5" x 7" card blank.

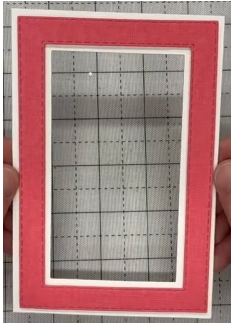

- Cut another piece of Coconut White Card to  $3\frac{3}{4}$ " x  $5\frac{3}{4}$ ". We then want to take the Dogwood Circle Flower die first and tape this down centrally onto your white card. Then take the top edging piece and add this just slightly above the circle flower and tape this down, it is very easy to line these 2 dies up together because if you look at the top of the Dogwood circle flower die there is a little notch, which matches up with a notch on the bottom of the top edging die. Then repeat this with the bottom edging piece, again matching up the notch on the bottom of the circle flower, tape these down and run through your die cutting machine.

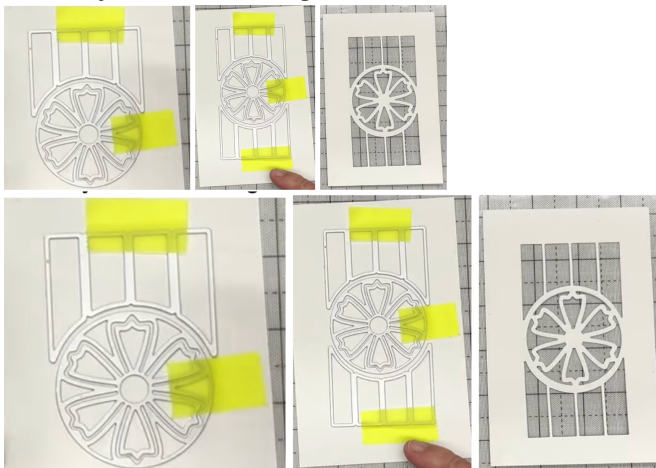

- Lay the die cut piece face down onto your Multipurpose mat, you will find that the sticky side does not stick to the mat. Then cut a  $3\frac{3}{4}$ " x  $5\frac{3}{4}$ " piece of double sided adhesive, remove the lined covering and add this onto the back of the main piece and press down. If you don't have the magic mat you need to add the cut frame onto the sticky side of the adhesive sheet.
- Then cut the same dies as above from 2 different shades of the Canvas Pink card and lay them out on your board. Then using your pick up tool to add the relevant colour pieces into the corresponding sticky areas of your card, so we are going to alternate them as we go along.

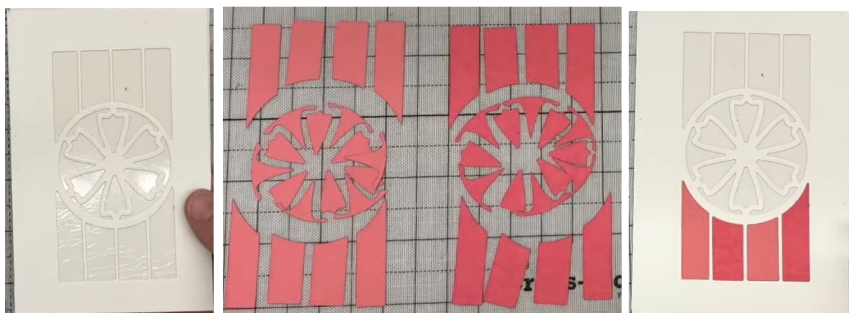

- John actually prepared 2 of the same base card, added the adhesive behind and used the remaining cut coloured pieces to make another card.
- Continue adding the darker red into the middle of the flower, then add the lighter pink around the outside, finally repeating the colours at the top of the card. You are then left with the remaining die cut pieces to make another card.

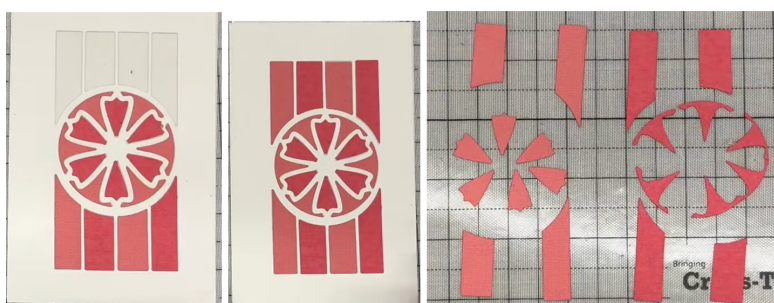

- Bring in your frame, remove the yellow backing from the foam tape, then hover over the front of your card until it is in the correct place and press down. If you see any pieces that are poking out of the back you can add your scissors at an angle and cut these off.



- Take your 5" x 7" card blank and add a layer of the lighter pink and coconut white card onto the front. Then add wet glue onto the back of your main card and add this onto the front of your card base.
- It is up to you how you decorate the front of your card; John has cut out a white set of the Stitched Vine Leaves and a set of the Dogwood Flower die from the 2 shades of pink canvas card. He has then layered them up and added a small white pearl into the centre.



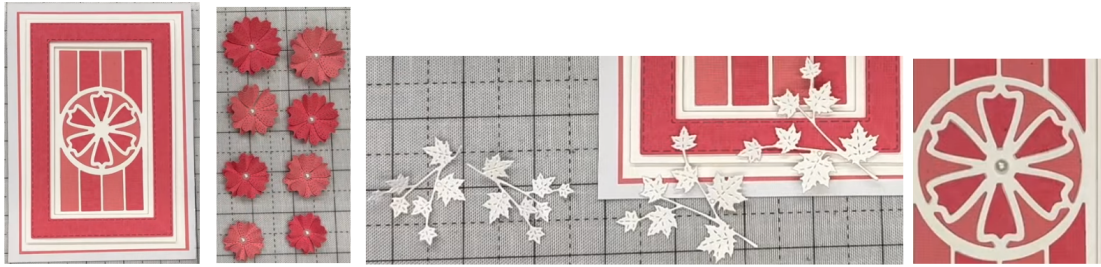

- Also, from Coconut white card he has cut out a set of the beautiful stitched Vine Leaves.
- Then added a small white pearl into the centre flower on your card.
- Using Glue Glaze add a little dab onto the back of each of the vine leaves, then add the 2 larger ones onto the bottom left-hand corner, then one of the smaller vine leaves on the bottom to create a triangle of leaves, just make sure that when you place the card into the envelope that the leaves are not hanging over the edge.



- To add the flowers, John is using CA Glue Gel with a cocktail stick to add the dogwood flowers onto the card. So, a large in the middle and a medium behind the large and then a smaller behind the top of the large flower, as you can see in the picture below.
- Then add wet glue onto the back of the remaining small leaves and add this onto the top right of your card. Then again using the Glue Gel and a cocktail stick add the smaller red Dogwood onto the leaves.



Your creation is now complete. I hope you have enjoyed these instructions.