

JND577 – Circle Stars - Christmas Wishes in Gold – 25 September 2025 - by John Lockwood



Instructions by June Smith

John has created a 'You Tube Video' dated 25 September 2025, using the new JND577 Robin Frame Die set, where he demonstrates how to make a Christmas card with the really strong Robin in the middle. I would advise that you visit it as well as following these instructions.

Information:

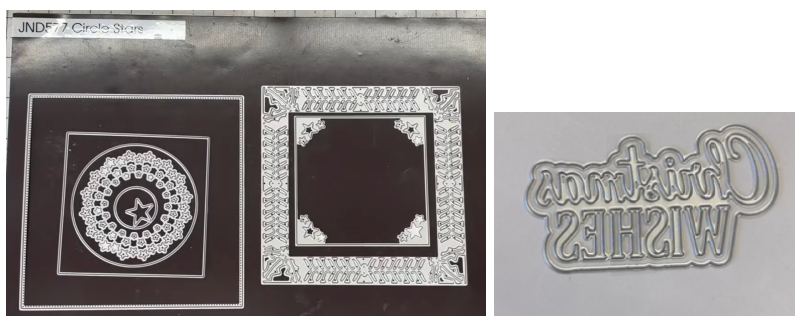

The cut in piece of this die doesn't need to be connected into the outer square as it just makes a beautiful cut in piece on its own. So let us see how this is made.

Materials.

7" x 7" Top Folding White Card Blank
JND577 Circle Stars Die set (8)
JND533 Slimline Poinsettia Die set (due out very soon)
JND558 Gold Wishes die set (2) – (due out very soon)
Gold Satin Card
Gold Mirror Card
Essential Coconut White Card
3D Glue Gel and Small Syringe
Glue Glaze
2mm Foam Tape
Craft Kit

Method:

- Take a piece of Gold Satin card cut to 5½" x 5½" and add the beautiful cut in die evenly onto it, tape it down and run through your die cutting machine to get this beautiful cut piece, it can be made into a stunning Christmas card, but can also be used for other times of the year, so a very versatile die, yes it has holly corners but you could easily add flowers all around the frame or just on the 4 corners to use this die all the year round. Add foam tape on the back of the square in the centre. Remove the backing and add onto a piece of Coconut white card cut to the same size 5½" x 5½", you can see then that we get that shadowing on the inside and you see all of that beautiful detail rather than it being flat.

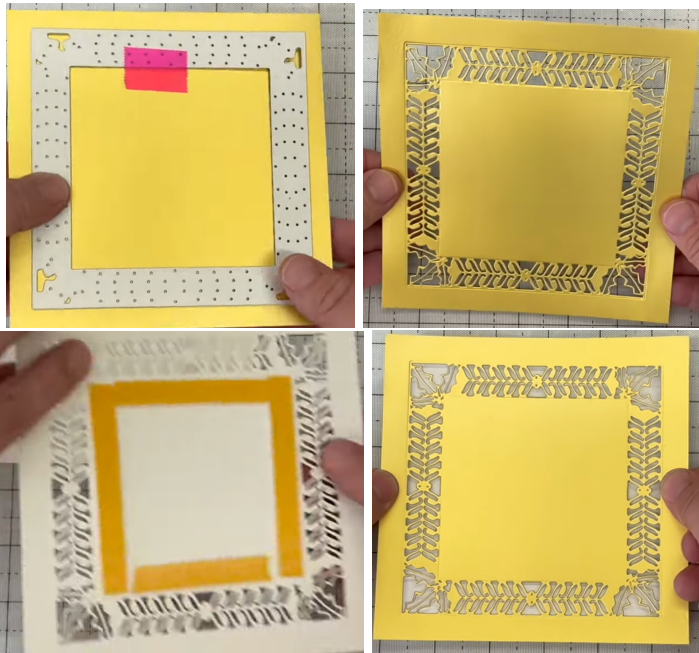

- Then take the inside plain cutting square and cut this out of coconut white card, then add foam tape onto the back, remove the yellow backing and adhere into the centre of your card so you get that balance of white to white.

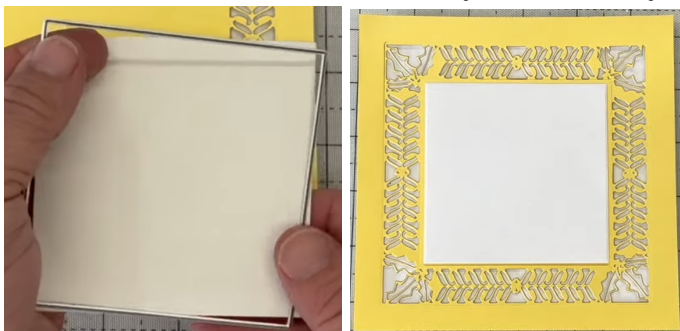

- Then take the next die in the die set and this is the one that fits inside the frame and has stars cut out of each corner and cut this out of coconut white card. Then cut a piece of gold mirror card cut to the same size as the die with the stars in and add this behind the white. Add foam tape onto the back, remove the yellow backing and add onto the front of your card.



- We are now going to add our wreath into the centre and to do this we need a scrap of Gold Mirror card and another of the Gold Satin Card, and we want the 3 sections so the smaller circle, the larger circle and the stars wreath circle die, take a long piece of low tack tape and pick up the small circle, hover over the wreath until it is even and press the tape down, then lift all the pieces up and hover over the outer circle until it is even all the way around and press down, you then have the 2 handles to lift the dies up and place this over the gold satin square, and run this through your die cutting machine. You then have this perfect circle with all the stars in it, use your poky tool to take all the stars out, we can use these to decorate some of our card and keep the rest for another project.

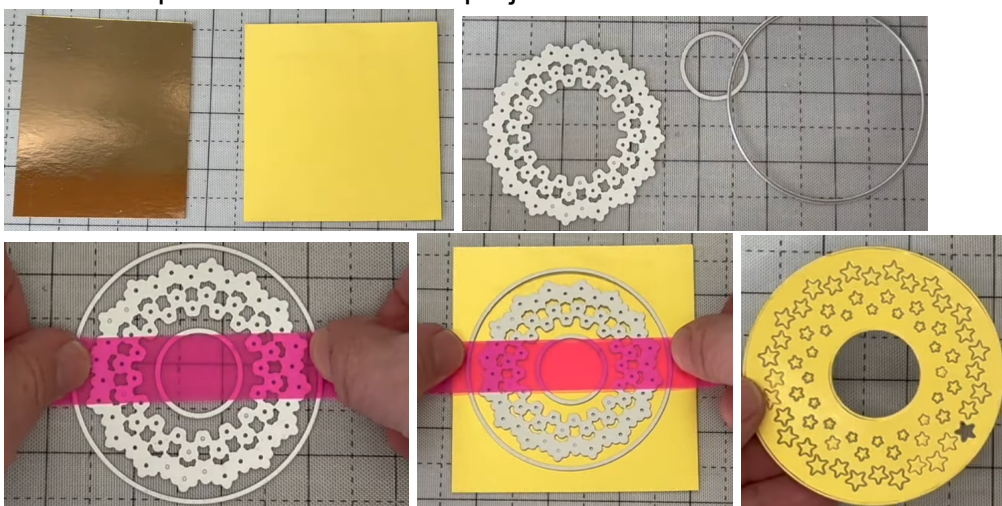

Top Tip: If you turn the circle over and there are still some stars that have not popped out, take your glue eraser and gently rub over the stars and they will fall out. Scoop them up and put into a little container as we can use them later.

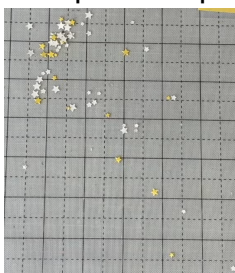

- Then add spray glue, for speed, onto the back of this star circle and add this onto the scrap of gold mirror card. Then take the large circle die and tape this down over the piece, then take the smaller centre ring and tape that

down into the middle , then run this through your die cutting machine, to give you this perfect stars circle wreath.

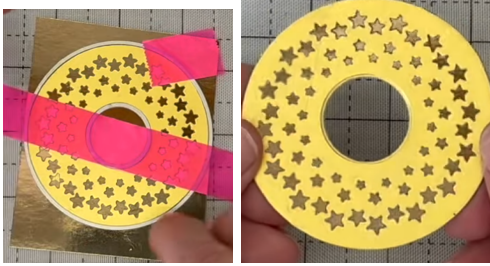

- John then has pre-cut a little banner which is $\frac{3}{4}$ " tall x roughly $3\frac{1}{2}$ " wide, he has cut out the JND 558 die that says 'WISHES' and added a small gold star at each end and tucked this in behind the middle circle and hanging over the top of the star circle, make sure it is even and carefully turn this over onto your table, normally we would add foam tape around the back of the circle, but first we want to add foam tape onto the end of the banner then take a strip of foam tape and remove the yellow backing, you can then guide the foam around the circle. Then using the stars to guide you, add this onto the front of your card. Then take a pair of scissors add them behind the banner, hold the left-hand side of the banner and pull the scissors gently towards the end of the banner to create a curl in it that works absolutely perfectly. Add foam tape onto the back.



- Then bring in your 7" x 7" top folding card blank and mat onto it a 6" x 6" square of the gold satin card and a $5\frac{7}{8}$ " x $5\frac{7}{8}$ " layer of Coconut White card. Take your main piece and remove the yellow backing from the foam tape and add this onto your top folding card blank.



- Then John has cut out some of the Slimline Poinsettia dies (these are coming out very soon), these have a little line in the middle of each petal, so it is easy to just fold them gently as valley folds, then add a small white pearl into the centre of them. We are going to use a syringe which has 3D glue gel in it to add the Poinsettias onto the front of the card. We add the 3 largest ones into the centre at the side of the Wishes Banner, then 3 into the top right-hand corner and finally 3 small ones in the bottom left-hand corner so we're keeping a sweep across the card.



Your creation is now complete. I hope you have enjoyed these instructions.