

JND595 Patio Leaves & JND581 Carol Flower - by John Lockwood



Instructions by June Smith

John has created a 'You Tube Video' dated 21st March 2026, using the new JND595 Patio Leaves (6), JND582 Carol Flower, JND586 Navajo set & JND587 Tahoe Frame set, where he demonstrates how to make a card. I would advise that you visit it as well as following these instructions.

Information:

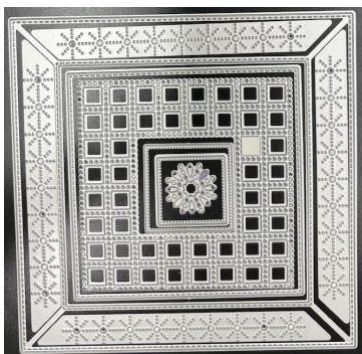

JND586 Navajo Die set (10)

Die 1: 6" x 6" Double Stitched $\frac{3}{4}$ " Wide Frame.

Dies 2-5: - Small Cross Flower Panels

Die 6: - Double Stitched Smaller Square Frame

Die 7 – Small Double Stitched Decorative Square Panel with the Square cut out

Die 8 – Slightly Smaller Double Stitched Square

Die 9 – Very Small Double Stitched Square

Die 10- Centre Flower Die

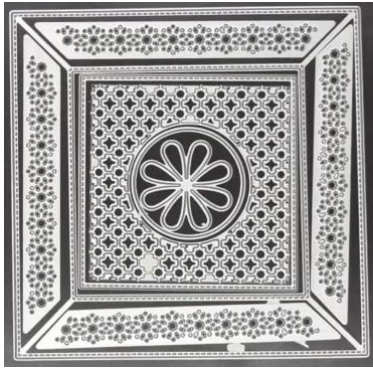

JND587 Tahoe Frame (9)

Die 1: 6" x 6" Double Stitched 1" Wide Frame

Dies 2-5: - Small Flower Panels

Die 6: - Double Stitched Smaller Frame

Die 7 – Decorative Square Panel with the circle cut out

Die 8 – Small Circle die

Die 9 – Flower Die

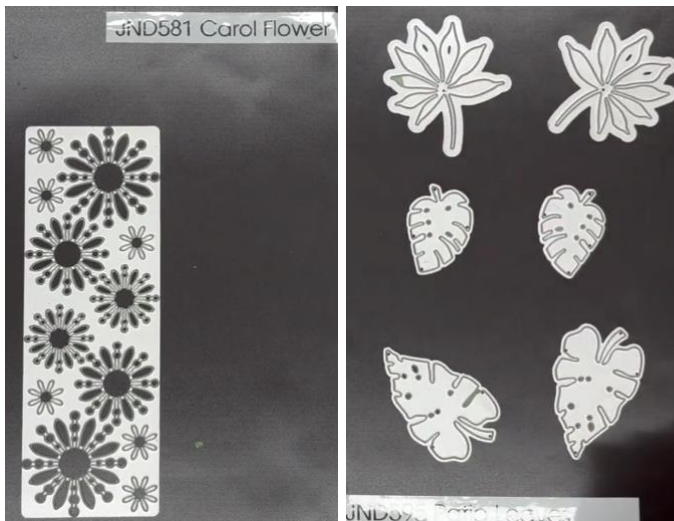

The Patio Leaves consists of 6 dies which are 3 pairs with a left and right facing.

Materials

7" x 7" White Top Folding Card Blank

JND595 Patio Leaves (6)

JND581 Carol Flower

JND586 Navajo (10)

JND587 Tahoe Frame (9)

Essential Coconut White Card

Canvas Card Lavender & Mulberry

Versafine Onyx Black and a Finger Dauber

Flower Moulding Foam Mat and Ball Tool

CA Faceted Blush Pink Gems

CA Stick on Pearls

Die Cutting Machine

CA 3D Glue Gel and a Cocktail stick

Glue Glaze
2mm Foam Tape
Craft Kit

Method:

- From a piece of the Canvas Lavender colour card add the 6 Patio Leaves die and tape them down well, we do this with any dies because if you don't tape the dies down well you find that they cross over and damage your dies when you run them through your die cutting machine. Remove the dies and remember the cut out piece of card is a perfect stencil to use on another card. Then take a finger dauber and pick up some of the Versafine Onyx Black ink and holding a leaf in the air just flick it round the outside edges of the leaves, this really makes them pop, don't do this on your desk top as we only want a light hint of the colour around the outside, you can see how this looks in the photo below. Then John has also pre-cut a set in the Mulberry Card and inked those as well.



- Then John has already cut the Carol Flower die out of the same colours of canvas card, you get 2 dies of the 3 different sizes of flowers as well as the centres or miniatures, he has also cut a set out of the Lavender and made them up as well.

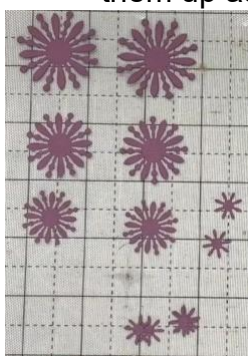

- We now want to shape them so bring in your Flower moulding foam mat and the ball tool that goes with it, place the flowers onto the mat, then just use your ball tool to circle in the middle just once, this will bring the outside petals up a bit, repeat for the 6 large flowers and for the small flowers just press the ball tool into the middle. Then bring in your Faceted Pink Blush gems and add one into the centre of each of the 4 large flowers and the medium size for the 2 smaller flowers, John uses a scalpel to pick up the sticky back gems, if you are doing this then please be careful that you don't cut yourselves, you can see in the photo below how the gems sparkle in the centre of the flower. When it comes to the tiny flowers add a little dab of glue glaze into the centre of 3 of them and rotate another one and add this on top, repeat so you have 3 flowers made. Then for the centre of these 3 flowers we will add one of the small Craft Artist Stick on pearls into the centre. You then have 9 different colour flowers in the Mulberry.

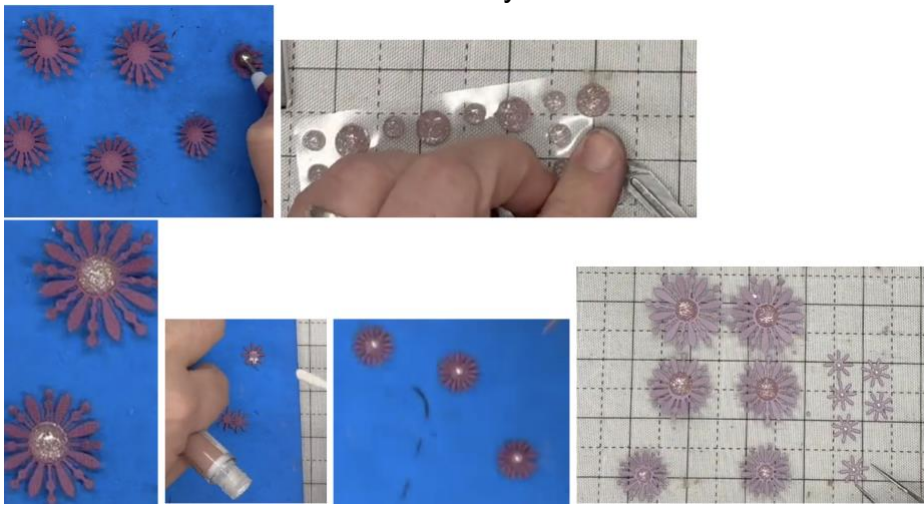

- John has pre-made a 7" x 7" base card with a layer of the Lavender and Coconut White card, he has also made a Lavender and Mulberry 6" x 6" frame using the frame dies No: 1 from both the Navajo and Tahoe die sets. He has also added behind the frame a Coconut White background using Die no: 7 – Small Double Stitched Decorative Square Panel with the Square cut out using the Navajo die set.



- We can now begin to decorate the front of our card; we will use 3D Glue Gel and a cocktail stick to add the flowers and leaves as this is the best product to use. Pick up one of the large Mulberry leaves and very gently fold it around

your finger to mould it slightly and add the gel behind just where the stem is, then add this onto your card. Repeat with the opposite leaf making sure that the stems are pointing into the middle. Then repeat with the Fern type ones and the smaller leaves.

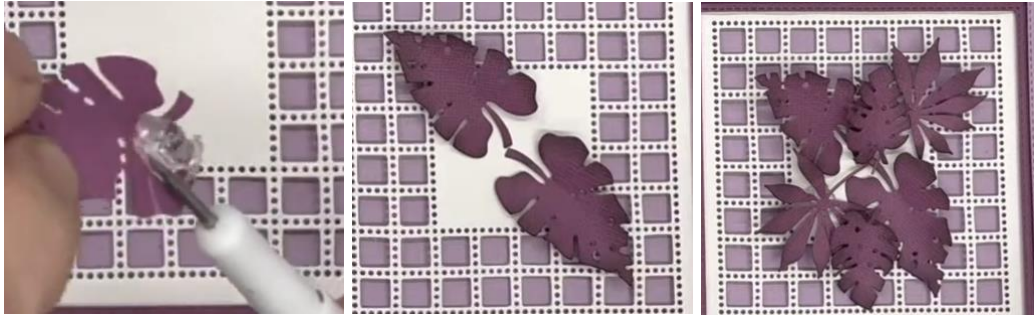

- Bring in 2 of the other colour leaves so they are working together and add these onto the front. We can then add some of the Flowers,



Your creation is now complete. I hope you have enjoyed these instructions.