

## Framed Silver & Blue Card with JND598 Tiarella FrameMaker & JND591 Skeleton Leaves Dies - by John Lockwood



Instructions by June Smith

John has created a 'You Tube Video' dated 15th May 2026, using the JND598 Tiarella FrameMaker, and JND591 Skeleton Leaves dies where he demonstrates how to make this beautiful card above. We will be using the Canvas Co-ordination Card though out the card. I would advise that you visit it as well as following these instructions.

### Information:

#### JND598 Tiarella (11)



- Die 1: - 4<sup>3</sup>/<sub>4</sub>" x 6<sup>3</sup>/<sub>4</sub>" Stitched Rectangle FrameMaker
- Dies 2 & 3: - 6" Vertical Ribbon Strips
- Dies 4 & 5: - 4" Vertical Ribbon Strips
- Die 6: 3' x 5" Plain Rectangle
- Die 7: 2<sup>3</sup>/<sub>4</sub>" x 4<sup>3</sup>/<sub>4</sub>" Outer Leaf Pattern
- Die 8: 3<sup>5</sup>/<sub>8</sub>" x 2" Oval
- Die 9: 3<sup>1</sup>/<sub>2</sub>" x 1<sup>7</sup>/<sub>8</sub>" Inner Leaf Pattern
- Die 10: Outer Leaf
- Die 11: Inner Leaf Pattern

### Materials:

- 6" x 8" Top Folding Card Blank
- JND591 Skeleton Leaves

JND598 Tiarella FrameMaker (9)  
JND597 Viola FrameMaker (14)  
JND Stamps 'Best Wishes'  
Coconut White Card  
Silver Linen Card  
3mm Dark Blue Ribbon  
Canvas Co-ordination Card – Marine Blue  
Sellotape  
CT902 Precision Stamping Block  
CT2038-7904 CA Wooden Bow Maker  
3M Permanent Spray Adhesive  
Die Cutting Machine  
Craft Kit

**Method:**

- Take Die no: 1: - 4 $\frac{3}{4}$ " x 6 $\frac{3}{4}$ " Stitched Rectangle Frame Maker and tape this down onto a piece of the Silver Linen Card as close to the edge of the card as you possibly can, then cut off the excess card as we can use this later and run this through your die cutting machine. You then get this stunning frame with the stitched detail around the inside and outside of the frame, so beautiful. Add some of the new CA foam tape onto the back and put to one side for a moment.

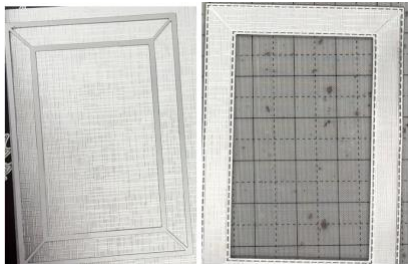

- Next we want to take a piece of the Marine Blue card from the Canvas Co-ordinations pack cut to slightly short of 4 $\frac{3}{4}$ " x 6 $\frac{3}{4}$ ", and place the silver frame over the top, then take die no: 6 which is the 3' x 5" Plain Rectangle and place this evenly in the middle of the frame and tape that down, then remove the frame and run this through your die cutting machine. Then bring back in your Silver frame and remove the foam tape covering and add this frame evenly over the blue frame, you then get the stunning blue around the inside of the frame.

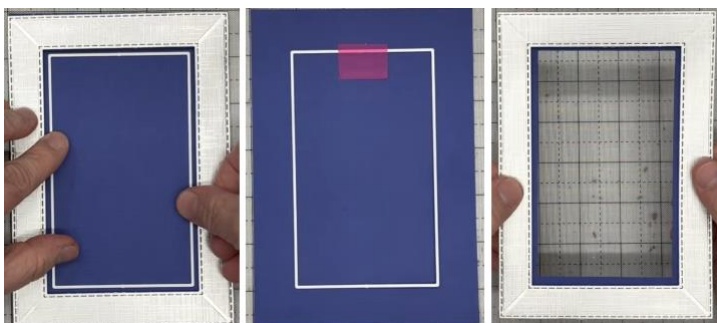

- Turn the frame over and again add some of the new CA Foam tape onto the back but don't remove the covering yet, so pop to one side.
- Cut a piece of Coconut White card again cut to that smaller size 4¾" x 6¾", and place this evenly on your magic mat, then take dies 2 & 3: - 6" Vertical Ribbon Strips and tape them down at the 1" and 2" marks, then run through your die cutting machine. Then repeat this adding the 2 dies at the 3" & 4" marks so you end up with 4 of the Ribbon Strips on your card.
- John has already cut his out and added a piece of the dark blue ribbon and taken his scissors and snipped the top corner off at an angle, see photo below, so it is easier to thread the ribbon through the slots. He has then already threaded the 2 outside strips so he took the ribbon and came up from the back and over into the next slot and continued this to the top slot.
- Then for the 2nd strip he reversed the ribbon, so he went in through the bottom slot and up through the next one all the way to the top. John is then showing on the video how he did the 3rd ribbon strip. So he went through the bottom, turned the card over and through the next slot, turned it back and repeated this sequence all the way to the top, that way it is easy to keep the ribbon from twisting. I hope this makes sense. Oh, a quick tip, if you put your finger through the loop of the ribbon as you thread it through you will find that it doesn't twist.

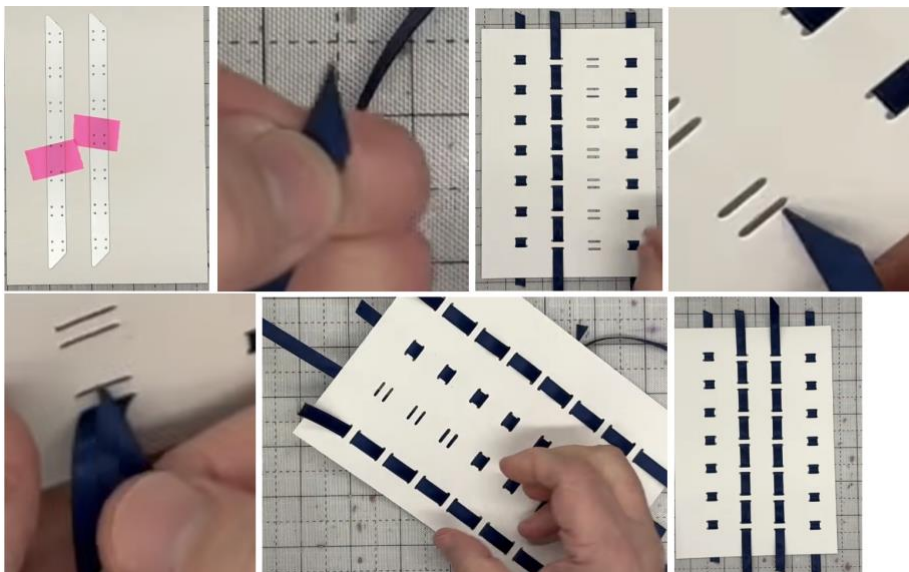

- Then bring back in the frame and reveal the foam tape then add this over the ribbon strip piece so that the 2 outside strips are just showing slightly each side and the middle 2 longer ribbon strips are seen in all their glory. You can then take your scissors at an angle and snip off the excess card on the right side only.

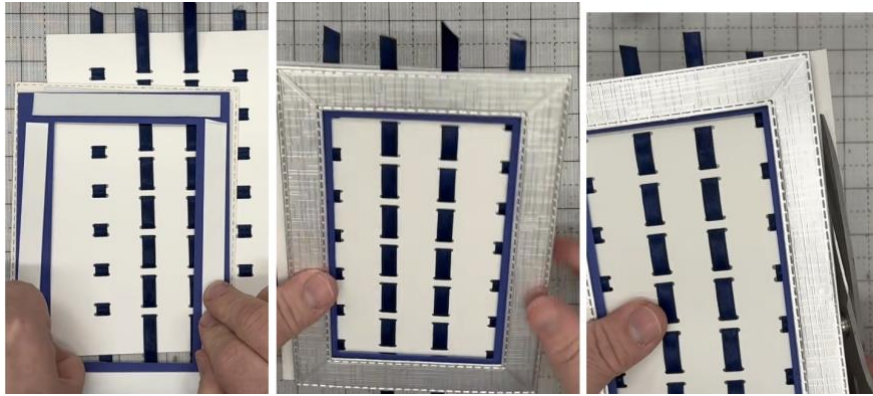

- Then turn the card over and we want to seal the ribbon, so take ordinary Sellotape and add a strip over the top and bottom ends of the card, this will stop the ribbon from moving and we can then snip off the excess overhanging ribbon and any of the background card showing. There is our background piece already done.



- Next we need to take Die 8: 3<sup>5</sup>/<sub>8</sub>" x 2" Oval and cut this out from the same Marine Blue card, then taken the Oval from the Viola die set and cut that from Coconut White Card, he has already stamped the 'Best Wishes' stamp using the CT902 Precision Stamping Block onto the middle, then added a strip of foam tape on the back of this white oval, revealed the tape and added this onto the Blue Oval. Then added 2 piece of the foam tape side by side on the back, reveal the tape and add this just a bit below the centre on the front of the card.



- We then want to bring in the CA Bowmaker and make a blue bow. There is a separate video and instructions on the website showing step by step how to make not only this bow but many other types of bows. You can download and printed it out for future reference.

- Wrap the blue ribbon around the bottom 2 pegs and cross them over at the bottom,

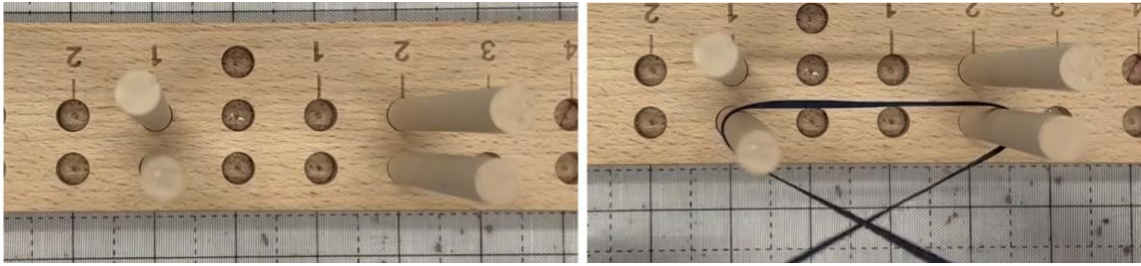

Then round the pegs again and cross them in the front

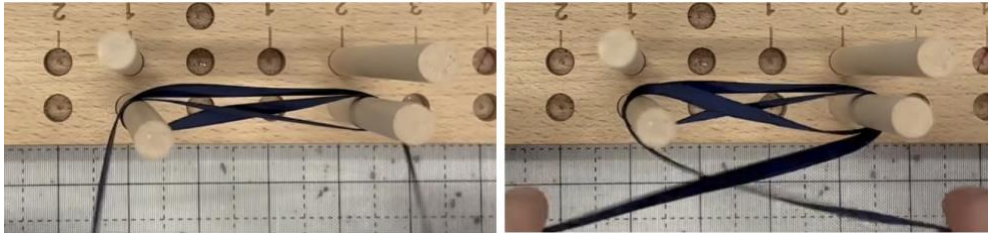

Then round the pegs again and bring the left hand ribbon under the right hand ribbon and over the top and round the middle of the bow and then repeat so you go around the middle twice and you have the 2 ends of the ribbon at the front.

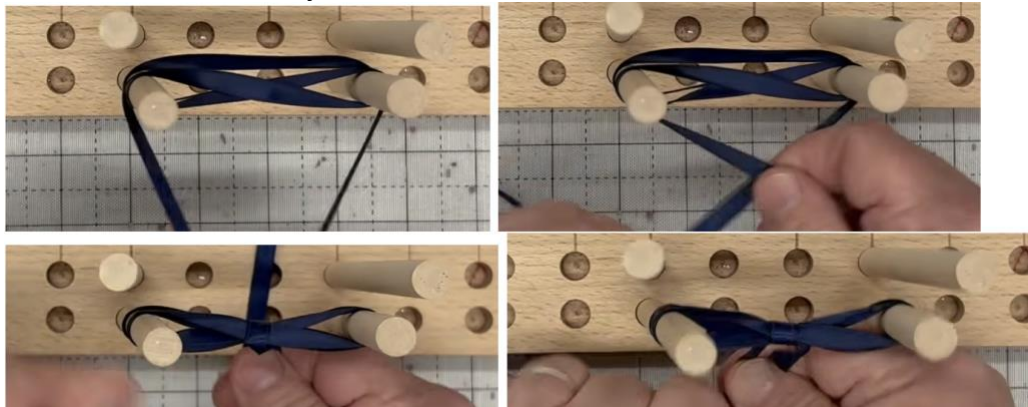

Tie a knot in the front and snip off the excess ribbon at an angle as fishtails.



- Then position the bow on the bottom left of the oval so you can still see the sentiment. Put to one side for now.



- We now want to make the leaves; John is demoing how to cut and make up the Solid Blue with the Silver outline on them and another of the Silver solid

with the blue outline on it. He has already previously made another of the solid blue with the silver outline on it.

- So, tape down Die No: 10, Outer Solid Leaf and Die No: 11 Inner Leaf Pattern dies onto a scrap of the Silver Linen card and run that through your die cutting machine, remove the fall away waste pieces. Then we are going to do exactly the same with the Blue piece of card.
- We then want to add both the Inner Leaf Patterns face down into our spray box and spray 3M Permanent Spray Adhesive onto the back of them, then we can add the silver onto the solid blue leaf and the blue onto the solid silver leaf.



- Bring in your 6" x 8" top folding card blank and add a layer of the blue and another of the Coconut white card onto it. Then add wet glue onto the back of the main ribbon piece and also in between the ribbon rows and add this onto the front of the card blank.



- Then using 3D glue Gel and a cocktail stick add a fairly large blob of the gel onto the back of the bow and add this just below the sentiment.



- Take all of the 3 Leaves and pinch them slightly so you have a Valley, Mountain and another Valley fold down the middle.
- Then add a bit of 3D Glue Gel onto the back Blue Solid and Silver outline and adhere this onto the top of the ribbon bow. Then repeat the time adding the Silver solid and blue outline leaf pointing down towards the bottom left corner.

- Finally add a bit of 3D Glue Gel onto the back of the remaining leaf and add this onto the ribbon so that it is pointing down towards the bottom right corner.



Your creation is now complete. I hope you have enjoyed these instructions.