

## JND609 Rochelle & JND610 Salisbury - DL Lattice Card - by John Lockwood



Instructions by June Smith

John has created a 'You Tube Video' dated 7th June 2026, using the new JND609 Rochelle DL FrameMaker die set and JND610 Salisbury DL FrameMaker die set, as well as JND438 Anastasia Flower Die & JND363 Peony Leaves Die, where he demonstrates how to make this beautiful elegant card above. I would advise that you visit it as well as following these instructions.

### Information:

The frame die itself matches together with the JND609 Rochelle Die Set, see the instructions for this already on the website.



JND438 Anastasia Flower Die  
JND363 Peony Leaves (12)

### JND609 Rochelle Die Set (7)

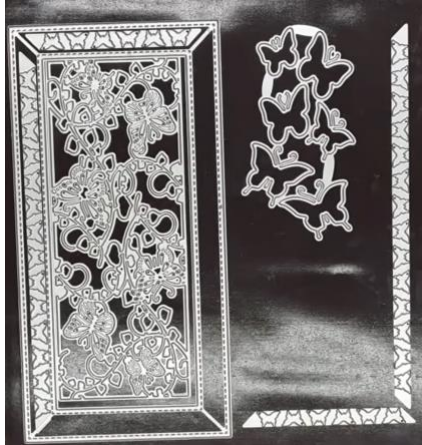

- Die 1 – Perfect DL size, stitched detail, FrameMaker die 4" x 8" and  $\frac{5}{8}$ " wide
- Dies 2 & 4 Butterfly Panel dies about  $7\frac{1}{2}$ " long
- Dies 3 & 5 Butterfly Panel dies  $3\frac{3}{8}$ " long
- Die 6 – Beautiful Butterfly Panel die  $2\frac{1}{2}$ " x  $6\frac{1}{2}$ "
- Die 7 – Butterfly Panel which cuts out 6 solid Butterflies

### JND610 Salisbury Die Set (6)

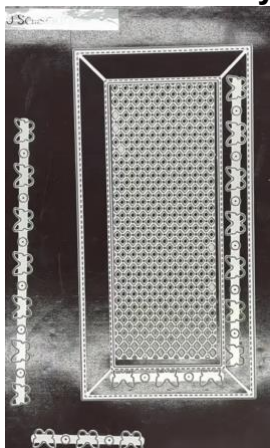

- Die 1 – Perfect DL size, stitched detail, FrameMaker die 4" x 8" and  $\frac{3}{4}$ " wide
- Dies 2 & 4 Outline Butterfly Panel dies about  $6\frac{5}{8}$ " long
- Dies 3 & 5 Butterfly Panel dies  $2\frac{5}{8}$ " long
- Die 6 – Lattice Shape Panel die  $2\frac{3}{8}$ " x  $6\frac{3}{8}$ "

#### Materials:

- 4 $\frac{1}{4}$ " x 8 $\frac{1}{4}$ " White Top fold card (made from A3 card)
- JND609 Rochelle Die Set (7)
- JND610 Salisbury Die Set (6)
- JND438 Anastasia Flower Die
- JND363 Peony Leaves (12)
- CA Essential White Card
- Silver Satin Card
- Canvas Card – Summer Greens - Dark Green and Mid Green
- VersaFine Clair – 'Cheerful' ink pad and separate finger dauber

Clear Dew Drops  
3D Glue Gel and a cocktail stick  
2mm wide Foam Tape  
A4 Die Cutting Machine  
Craft Kit

**Method:**

- Take an A4 sheet of Coconut White card and place this evenly onto your multi-purpose mat, or a mat with lines on. Then bring in both frames and tape them down side by side then run this through your A4 die cutting machine. Remove the waste pieces but keep them as we will use them later. Then add foam tape onto the back of the smaller width frame and add onto the slightly wider frame.

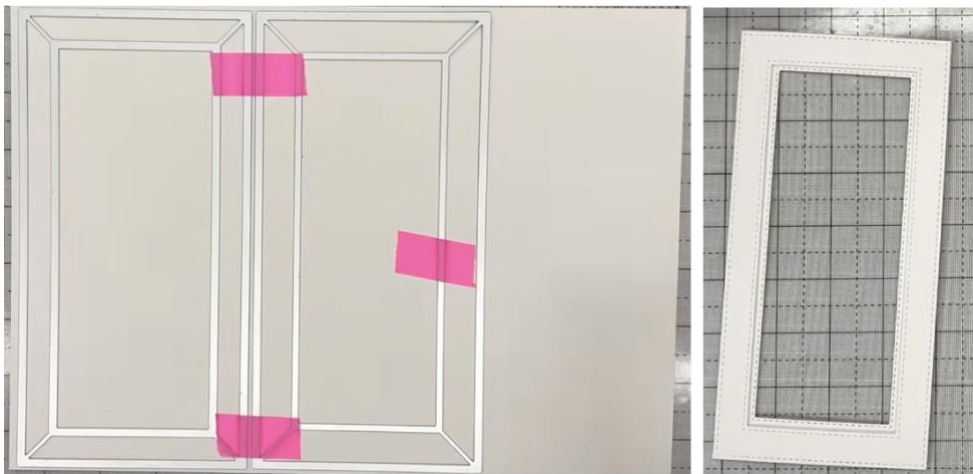

- Take one of the scrap pieces left over from cutting the frame and tape down die no: 6 which is the lattice shape panel from the Salisbury die set, then run this through your die cutting machine. Then when you remove the die you have the perfect lattice pattern like little diamond shapes in the middle and all the pieces fall out easily, we are not going to be doing this now, but you could add the die onto the right side of the die cut and click it back in to extend the pattern if you wanted.

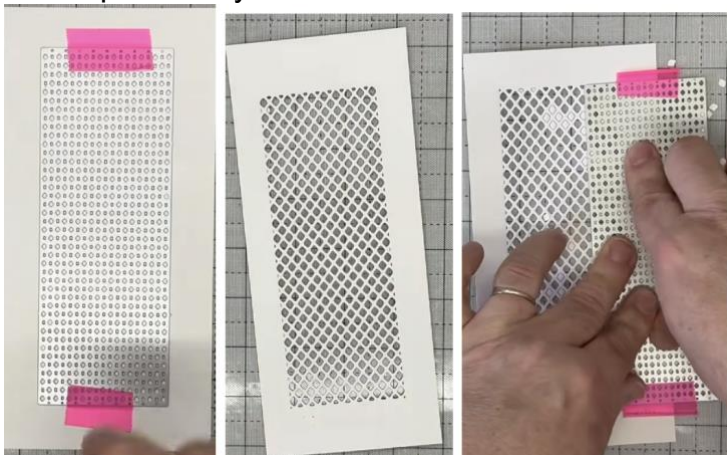

- Turn the main frame over and add foam tape around the outside, remove the yellow backing and add this evenly over your cut lattice piece. If you have any overhanging pieces showing simply take your scissors and tilt them at an

angle and snip off the excess that you can see from the front. You then have the perfect little lattice DL frame.

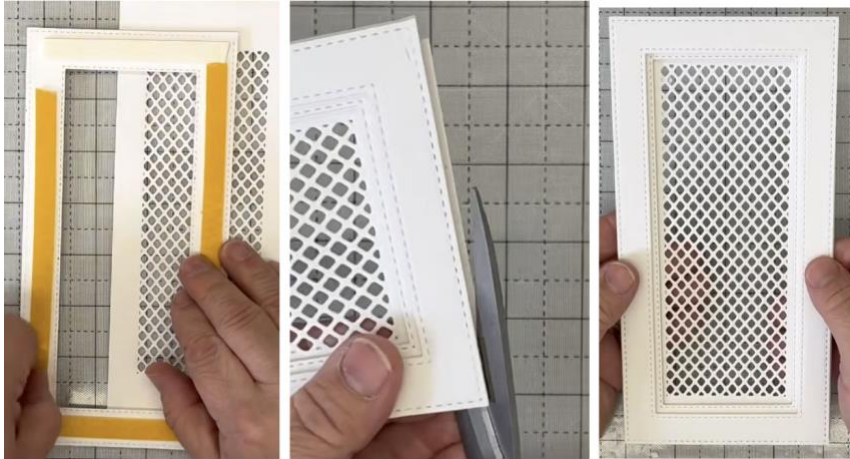

- Turn the card over and add 2mm wide foam tape onto the back of the frame, remove the backing and add a piece of Satin Silver card onto it. There we have our perfect beautiful piece.



- We now want some flowers and leaves to decorate onto the frame, John has already cut out a set of the Anastacia Flower from Coconut white card and laid them out onto his lined mat, so there is 3 extra-large, 3 large, 2 medium and 2 small, he has already put together a set of the flowers but will show us now how these were coloured and put together. Take your finger dauber and pick up some of the 'Cheerful' yellow ink and scribble in the middle of each flower.



- Add a dab of glue glaze into the middle of the 3 extra-large and 2 medium flowers, then add a large offset onto an extra-large and rotate it round, repeat for the other 2, then do the same for the small onto the medium 2 flowers. Bring in a piece of flower moulding foam and a 4-in-1 tool and leaving the cap on the tool just press down into the middle of each flower to raise the petals up slightly.

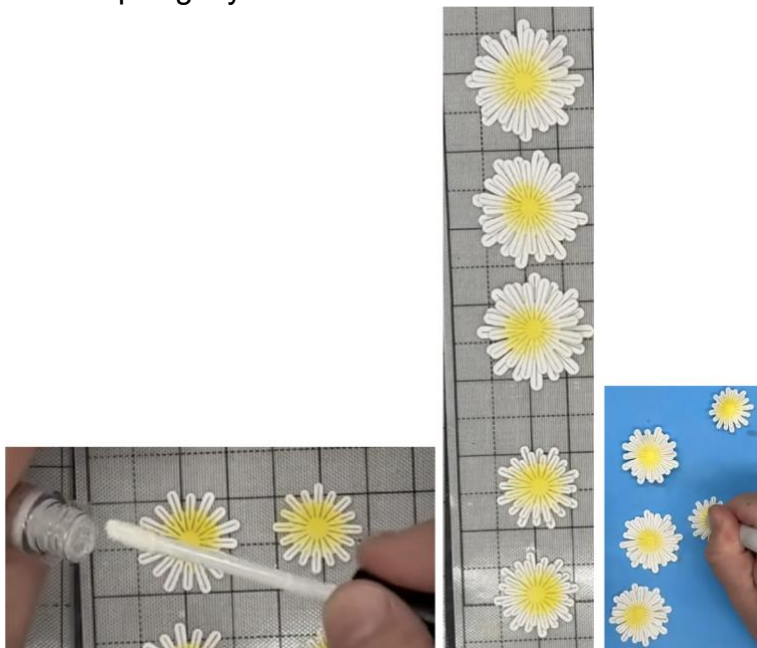

- Bring in your clear dew drops and add your glue glaze into the centre of each flower and add a dew drop into the middle and pick up the sides to shape them. Tip: if you used normal wet glue into the middle and add your dew drop onto it, you will find that it can take up to 24 hours to dry, whereas glue glaze is the best thing to use and dries in about 30 seconds. So, you end up with 5 beautiful flowers, John has already cut out and put together a set of 5 of the flowers so you have 10 in total.

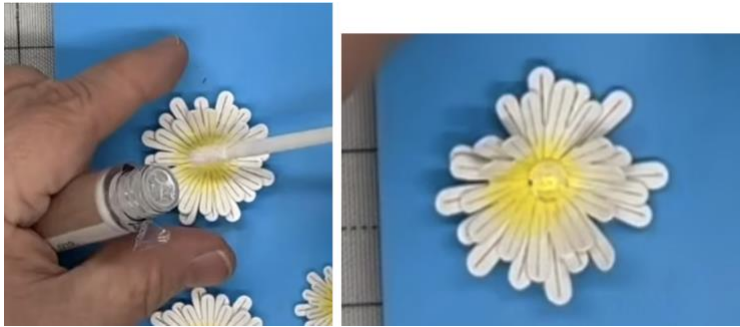

- John has already made a 4¼" x 8¼" White Top fold card from A3 card and added a layer of dark green card onto it which is just slightly smaller. Add wet glue onto the back of your main piece and add this onto the dark green card.
- John has already cut and made up a set of the Peony leaves from 2 different greens from the canvas card in Dark Green and Mid Green, then used glue onto the back of the dark green leaves and added them onto the mid green background leaves. Add a little blob of 3D Glue Gel onto the bottom left inside of the frame and add a leaf onto it and add another little bob onto the frame just behind the tip of a leaf, I have added a photo of each stage of adding the leaves, the single large leaf has been bent slightly in half to give a bit of dimension at the bottom and top right.



- We can then add a little blob of Glue Gel onto the back of the Anastacia Flowers and add a large flower onto the top right leaves, and on the bottom left leaves adding 2 large and a medium flower onto there. Keep the remaining flowers for another project.



Your creation is now complete. I hope you have enjoyed these instructions.  
Such a beautiful card.

Why not visit the official page on Facebook or watch some more video's over here  
on our You Tube Channel, remember you can save each of these 'You Tubes' which  
you can refer back to whenever you need to.